



**415QR N**    **435SG-QR N**  
**415QRL N**    **452QR**  
**415SGH N**    **512QR N**  
**415SG-QR N**    **512SG-QR N**  
**416QR**    **516QR**  
**418QR**    **517QR**  
**435QR N**



Repair instructions

## FREQUENT USE

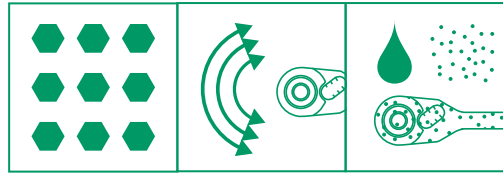

## INFREQUENT USE

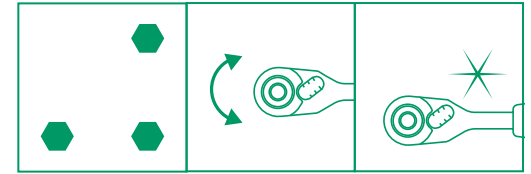

## SPARE PARTS

|  |      |             | NLGI-Class* |
|--|------|-------------|-------------|
| <b>415QR N</b><br><b>415QRL N</b><br><b>415SG-QR N</b><br><b>416QR</b><br><b>418QR</b> | 1/4" | 19 01 20 20 | 2-3         |
| <b>415SGH N</b>  | 1/4" | 19 01 00 13 | 2-3         |
| <b>435QR N</b><br><b>435SG-QR N</b><br><b>452QR</b>                                    | 3/8" | 19 02 10 20 | 2-3         |
| <b>512QR N</b><br><b>512SG-QR N</b><br><b>516QR</b><br><b>517QR</b>                    | 1/2" | 19 04 20 20 | 2-3         |

\*ASTM D217, DIN 51818

1

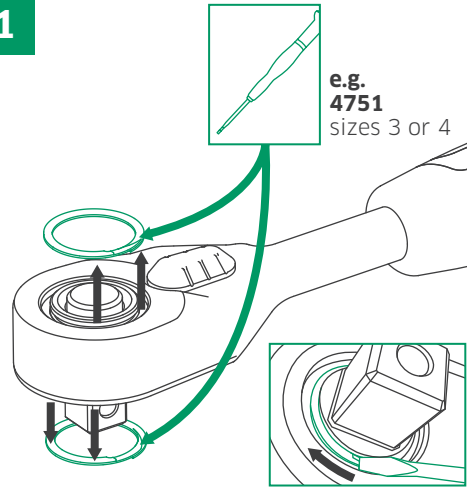

2

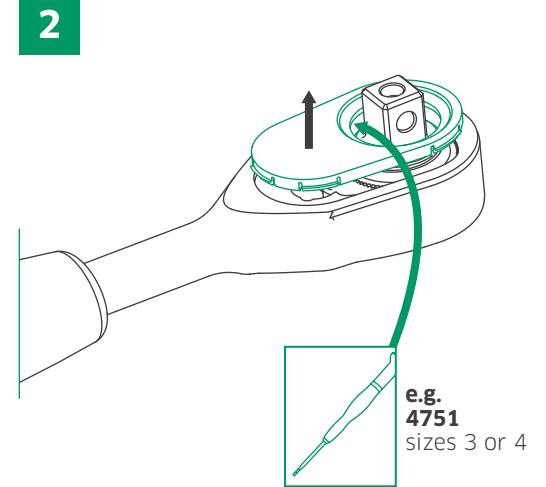

3

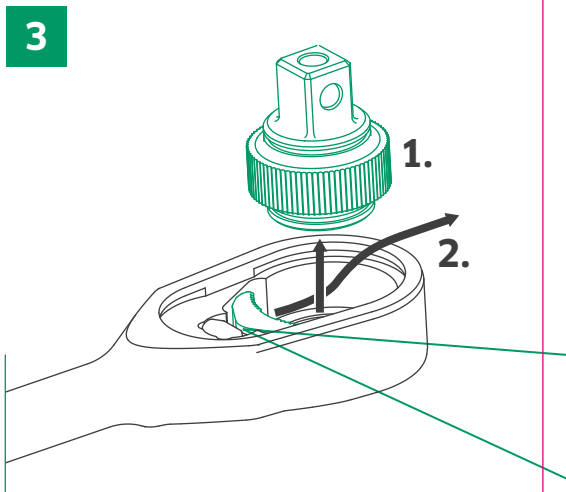

4

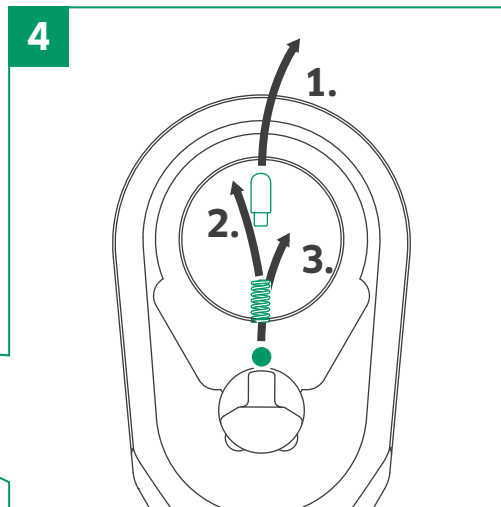

5

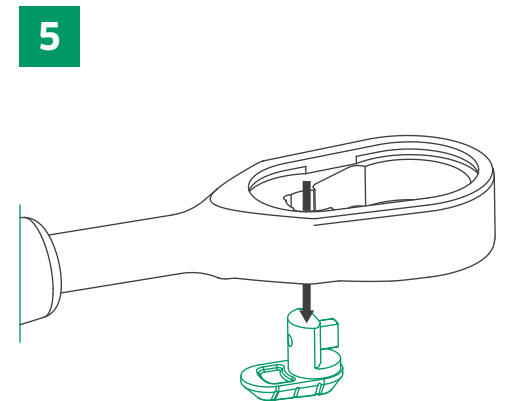

## 6 CLEAN

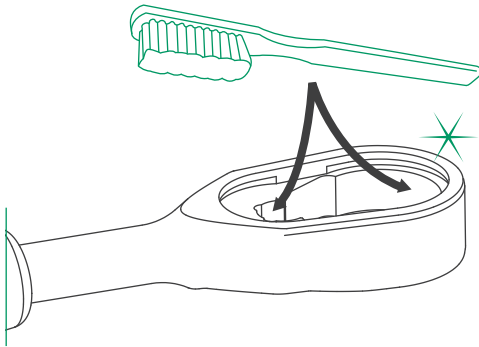

7

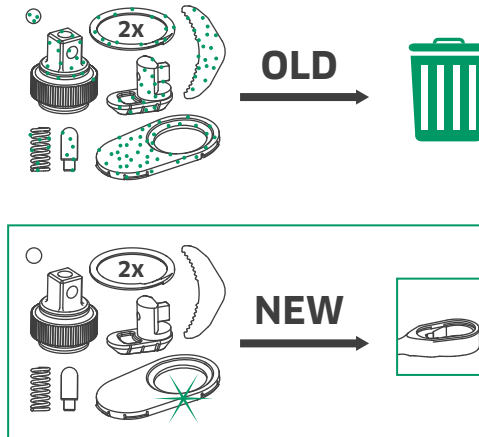

8

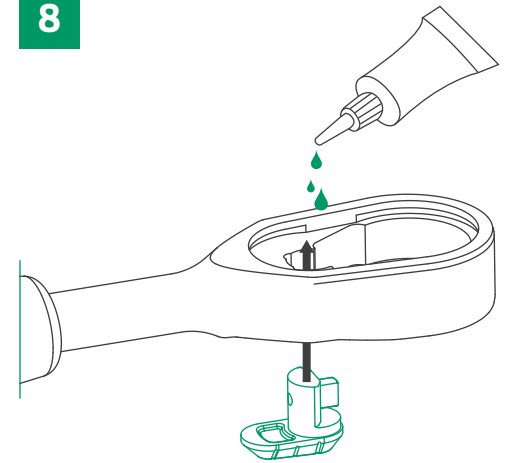

9

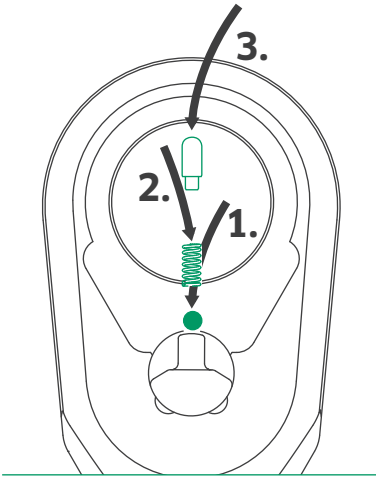

10

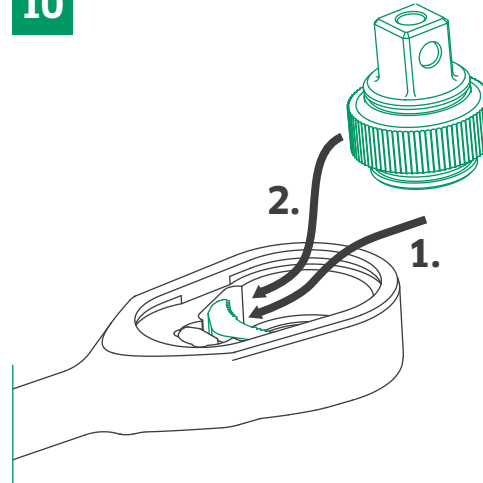

11

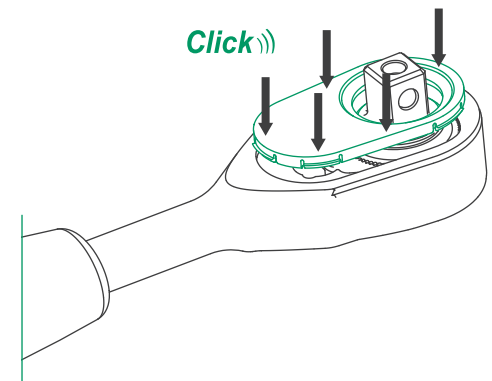

**Premium  
tool solutions**  
Made in Germany

STAHLWILLE Eduard Wille GmbH & Co. KG  
Lindenallee 27 · 42349 Wuppertal · Germany  
Tel.: +49 202 4791-0 · Fax: +49 202 4791-200  
support@stahlwille.de · www.stahlwille.de

91 97 97 98

Printed in Germany - Copyright by STAHLWILLE Eduard Wille GmbH & Co. KG,  
Wuppertal - 20/03/19 PAF

 Made in  
Germany

[service.stahlwille.de](http://service.stahlwille.de)



12

