



## KL-0039-23

### Set of Quick-Action Clamping Nuts



**Product information** EN  
 ⚠ Read and understand before use!



[www.gedore-automotive.com](http://www.gedore-automotive.com)



**GEDORE Automotive GmbH**

Breslauer Straße 41  
 78166 - Donaueschingen  
 Postfach 1329  
 78154 Donaueschingen - GERMANY

☎ +49 (0) 771 / 8 32 23-0  
 ☎ +49 (0) 771 / 8 32 23-90  
 ✉ info.gam@gedore.com  
 🌐 gedore-automotive.com

**GEDORE TOOLS, INC.**

Only for USA, Canada & Mexico / Sólo para EE.UU., Canadá y México  
 Seulement pour les USA, le Canada et le Mexique  
 7187 Bryhawke Circle, Suite 700  
 North Charleston, SC 29418, USA

☎ +1-843 / 225 50 15  
 ☎ +1-843 / 225 50 20  
 ✉ info@gedoretools.com  
 🌐 gedore.com

Version 1 - 04/2022

0039-23\_219\_EN220314.indd

## Product description

### KL-0039-23 - Set of Quick-Action Clamping Nuts

Universally suitable for the tools of the KL-0039-.. Series Wheel Bearing/Silentbloc Tool with pull spindles having either an M10x1.25, M12, M14, M16 or M20 retaining thread.

Thanks to their special design, the quick-action clamping nuts can be adjusted with ease - simply by sliding them on the pull spindle without any rotational movement. This allows for short assembly/clamping times as well as for quick and easy adjustment and simple operation of the tool.

**Note:**

To prevent the quick-release nut from opening under load, secure it by the collar together with a suitable pressure/support sleeve, an adapter, or a retaining ring.

**Recommended Accessory:**

KL-0039-2190 - Retaining Ring for M10, M12 and M14 Quick-Action Clamping Nuts

KL-0039-2191 - Retaining Ring for M16 and M20 Quick-Action Clamping Nuts

KL-0039-2192 - Retaining Ring for M16 and M20 Quick-Action Clamping Nuts

EN



### Scope of delivery / component overview

Item	Part no.	Description	Qty
1	KL-0039-2110-2	Quick-Action Clamping Nut, M10x1.25	1
2	KL-0039-2112-2	Quick-Action Clamping Nut, M12	1
3	KL-0039-2114-2	Quick-Action Clamping Nut, M14	1
4	KL-0039-2116-2	Quick-Action Clamping Nut, M16	1
5	KL-0039-2120-2	Quick-Action Clamping Nut, M20	1

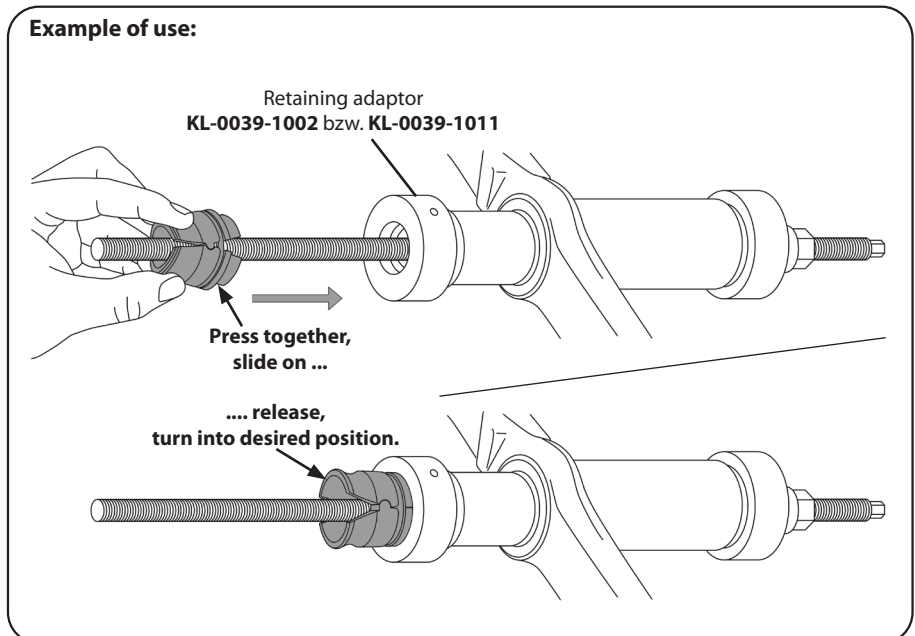

**Accessories:**

**KL-0039-2190 - Retaining Ring for M10, M12 and M14 Quick-Action Clamping Nuts**

The retaining ring is needed when a quick-action clamping nut having either an M10, M12 or M14 retaining thread is to be used without the **KL-0039-1011** adaptor.

Thanks to this ring, the respective clamping nut can quickly be adjusted on an M10, M12 or M14 pull spindle - simply by sliding it on the spindle without any rotational movement. This allows for short assembly/clamping times as well as for quick and easy adjustment and simple operation of the tool.

**KL-0039-2191 - Retaining Ring for M16 and M20 Quick-Action Clamping Nuts**

The retaining ring is needed when a quick-action clamping nut having either an M16 or M20 retaining thread is to be used without the **KL-0039-1002** adaptor.

Thanks to this ring, the respective clamping nut can quickly be adjusted on an M16 or M20 pull spindle - simply by sliding it on the spindle without any rotational movement. This allows for short assembly/clamping times as well as for quick and easy adjustment and simple operation of the tool.

**KL-0039-2192 - Conical Adaptor for M20 Quick-Action Clamping Nut**

The conical adaptor allows the **KL-0039-2120-2** quick-action clamping nut to be quickly adjusted on the **KL-0039-1920-1** pull spindle - simply by sliding it on the spindle without any rotational movement.

A very useful complement to the **KL-0041-380 EA** wheel hub puller and **KL-0041-740 E** wheel bearing tool set. This allows for short assembly/clamping times, as well as quick and easy adjustment and simple operation of the tool.



**Example of use:**

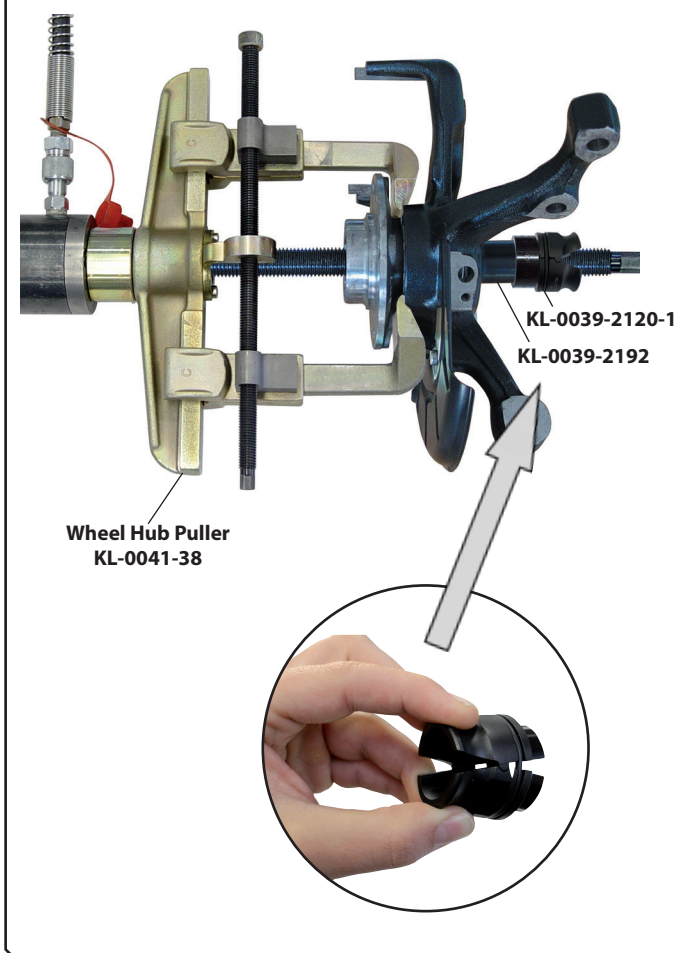

**⚠ Safety instructions and regulations**

- **Before using** the special tools, read and understand all safety instructions and **follow** them for **safe use!**
- Use the special tools **as intended** and **always** carry out maintenance and repair work in compliance with the regulations on occupational safety and accident prevention as well as the vehicle manufacturer's instructions!
- **Prior to each use**, check the special tools **carefully** for damage, loose parts or unauthorised modifications. **Never** use it if you notice any such deficiencies!
- **Always** wear your personal protective equipment (for example safety goggles, protective gloves, safety shoes) when working!

## GEDORE-Werkzeugfabrik GmbH & Co. KG

Remscheider Straße 149  
42899 - Remscheid  
Postfach 120361  
47873 Remscheid  
GERMANY

### Vertrieb DEUTSCHLAND

☎ +49 (0) 2191 / 596-0  
☎ +49 (0) 2191 / 596-230  
✉ info@gedore.com  
🌐 www.gedore.com

### Sales INTERNATIONAL

☎ +49 (0) 2191 / 596-910  
☎ +49 (0) 2191 / 596-911  
✉ info@gedore.com  
🌐 www.gedore.com

## GEDORE TOOLS, INC.

Only for USA, Canada & Mexico  
Sólo para EE.UU., Canadá y México  
Seulement pour les USA, le Canada et le Mexique  
7187 Bryhawke Circle, Suite 700, North Charleston, SC 29418, USA

☎ +1-843 / 225 50 15  
☎ +1-843 / 225 50 20  
✉ info@gedoretools.com  
🌐 www.gedoretools.com

Worldwide GEDORE service centers and offices are listed on the Internet at: [www.gedore.com](http://www.gedore.com)

## GEDORE Automotive GmbH

Breslauer Straße 41  
78166 - Donaueschingen  
Postfach 1329  
78154 Donaueschingen  
GERMANY

### Vertrieb DEUTSCHLAND

☎ +49 (0) 771 / 8 32 23-0  
☎ +49 (0) 771 / 8 32 23-90  
✉ info.gam@gedore.com  
🌐 gedore-automotive.com



[www.gedore-automotive.com](http://www.gedore-automotive.com)