

GEDORE

TOOLS FOR LIFE

Wheel Bearing Tool Kit with 17t Hydraulic Cylinder (German Utility Model)

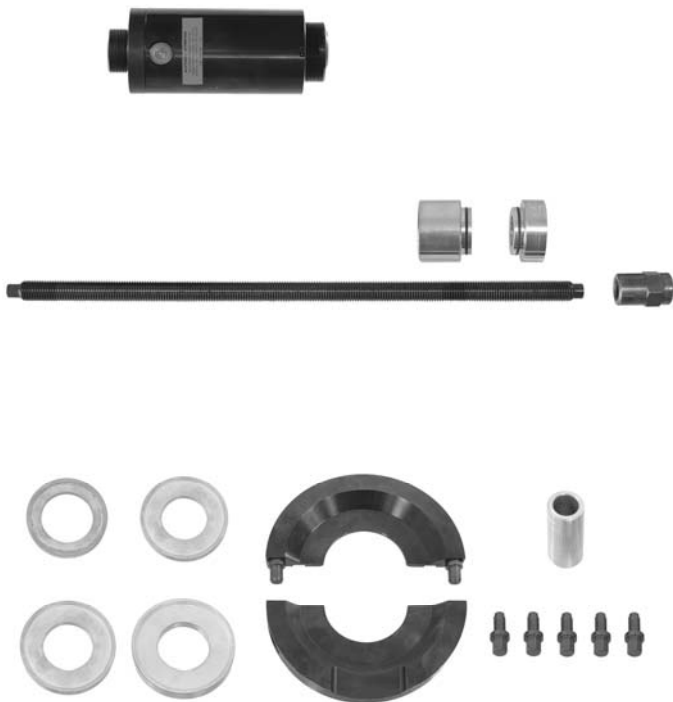

KL-0041-45 B

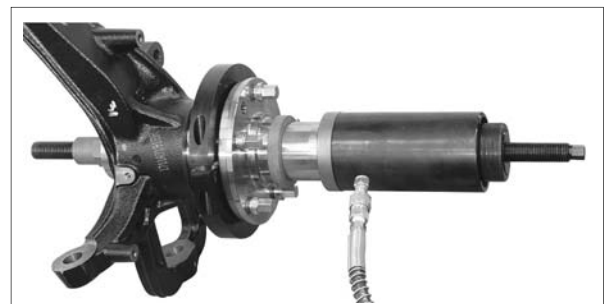

0041-45Be140219.docx

GEDORE Automotive GmbH

Breslauer Straße 41
78166 Donaueschingen

Postfach 1329
78154 Donaueschingen - GERMANY

Phone.: +49 (0) 771 / 8 32 23-0
Fax: +49 (0) 771 / 8 32 23-90

Email: info@gedore-automotive.com
Internet: www.gedore.com

Fig. 1: KL-0041-45 B

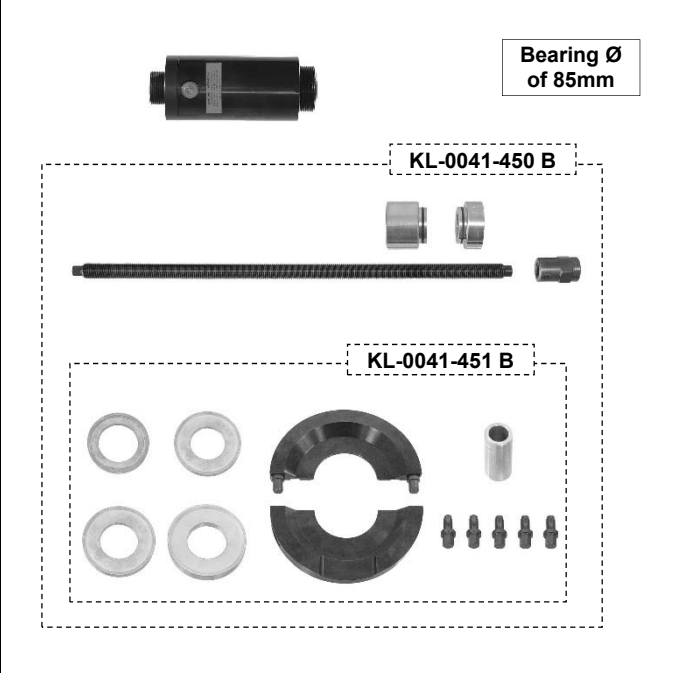

Wheel hub bearing unit removal:

Accessory:
KL-0041-38 - Wheel Hub Puller, with Adjusting Spindle,
17t Hydraulic Cylinder

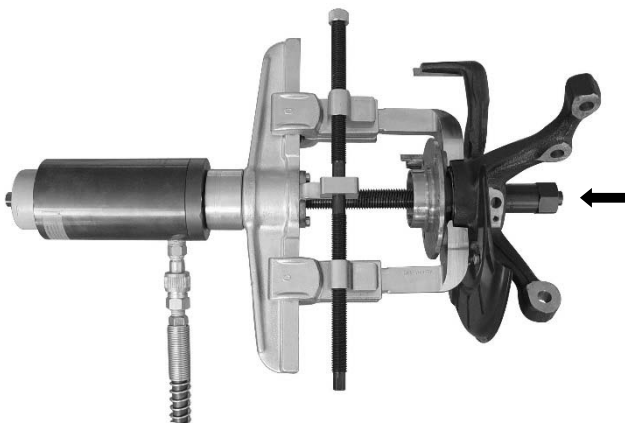
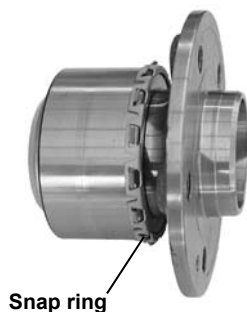

Fig. 2: Wheel hub bearing unit



**KL-0041-45 B -Wheel Bearing Tool Kit
with 17t Hydraulic Cylinder
(German Utility Model)**

Suitable for vehicles with bearing Ø of 85mm such as VW T5 (front and rear axle), VW Touareg and Porsche Cayenne (front axle).

Field of Application

The **KL-0041-45 B** wheel bearing tool enables the quick and safe *installation* of wheel hub bearing units without the risk of damaging them.

Note: ⇒ Wheel hub bearing unit removal:

For the removal of wheel hub bearing units, the **KL-0041-38** wheel hub puller will be needed.

Technical Data

Maximum load capacity of the hydraulic cylinder: 17t
Maximum load capacity of the pull spindle: 20t
Weight:..... 15.8kg

Warnings and Notes

- Any work on vehicle axles should only be performed by qualified specialist personnel observing and complying with the directions, provisions, and safety regulations specified by the vehicle manufacturer!
- When working with hydraulic tools, special safety regulations have to be observed.
- Before use, lubricate spindle with molybdenum disulphide paste **KL-0014-0030**.
- Always keep all parts of your body away from the line along which the hydraulic cylinder extends or retracts.
- For the removal of wheel hub bearing units, the **KL-0041-36** or **-38** wheel hub puller will be needed.
- A hydraulic pump such as **KL-0215-35 M25** or **KL-0215-37 M25** will be needed to drive the **KL-0040-2500** hydraulic cylinder.

Fig. 3: Installing the Wheel Hub Bearing Unit:
Mounting the clamping shells.

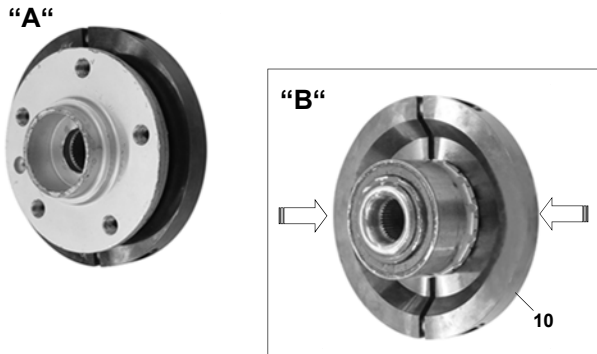
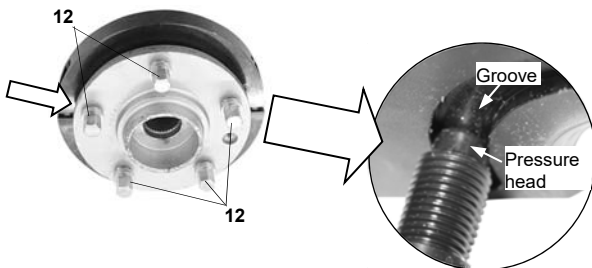

Fig. 4: Mounting the pressure screws.

“A” Uniformly screw pressure screws into wheel hub.



“B” Uniformly tighten pressure screws.



Fig. 5: Mounting the tool to steering knuckle/stub axle.

Depending on application, use:
“9” (with front axle on T5)
“8” (with rear axle on T5)
“7” (with front axle on Touareg, Chayenne)

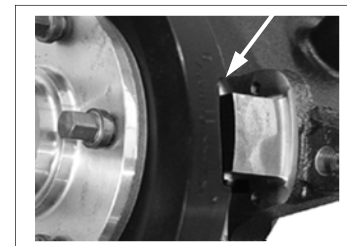
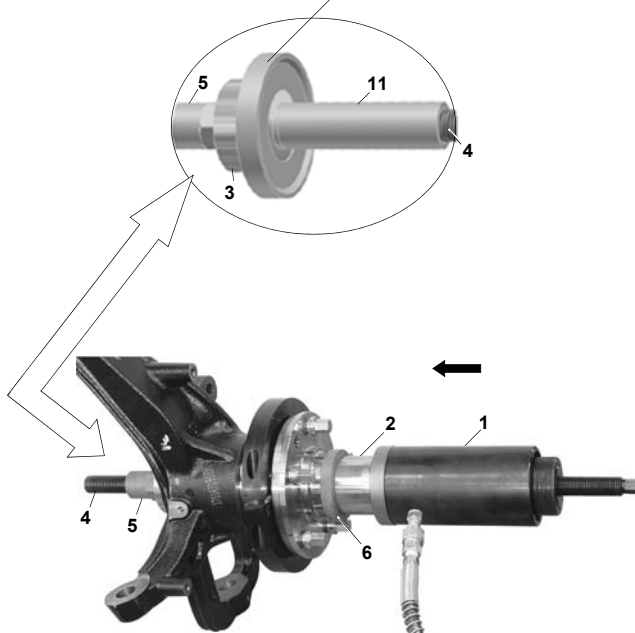

Correct Use

Installing the Wheel Hub Bearing Unit:

1. Mount clamping shells **Pos. 10** to wheel hub bearing unit as shown in **Fig. 3 A and 3 B**.
2. Uniformly screw pressure screws **Pos. 12** into wheel hub until pressure head (unthreaded part of the screws) engage and fit in the groove of the clamping shells. (**Fig. 4 A**). Uniformly tighten pressure screws in a crosswise sequence. (**Fig. 4 B**).

Note: If necessary, check that screws are level with one another using a vernier calliper.

3. Mount tool to steeringknuckle/stub axle as shown in **Fig. 5**.

Attention:

- With the front axle of **VW T5**, use **KL-0039-1502** pressure ring (**Pos. 9**).
- With the rear axle of **VW T5**, use **KL-0039-1289** pressure ring (**Pos. 8**).
- With the front axle of **VW Touareg, Porsche Cayenne**, use **KL-0039-1283** pressure ring (**Pos. 7**).



Note:

Some models of the VW T5 Series feature a protruding part on the rear wheel bearing housing. When aligning the clamping shell halves on these vehicles, make sure that the recess in the clamping shells is located in the area of the protruding part. (**See illustration below**)

4. Operate hydraulic pump and install wheel hub bearing unit into wheel bearing housing.
5. Stop the installation process as soon as the snap ring latches into the groove and the wheel hub bearing unit is positioned correctly.
6. Remove tool, check position of wheel hub bearing unit and reassemble vehicle according to the manufacturer's directions and instructions.

Scope of Delivery: KL-0041-45 B

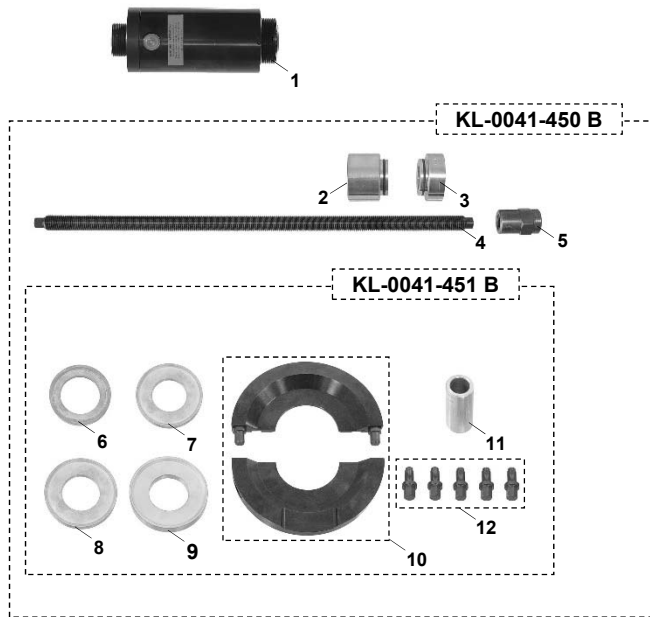

Accessory:
KL-0041-38 - Wheel Hub Puller, with Adjusting Spindle, 17t Hydraulic Cylinder

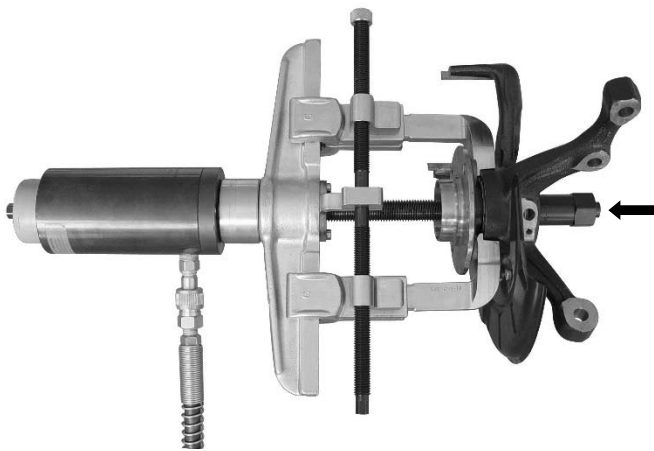

Accessory:
KL-0215-35 M25 - Hydraulic Hand Pump



Scope of Delivery

Pos.	Part No.	Description	Qty
-	KL-0041-45 B	Wheel Bearing Tool Kit, with 17t Hydraulic Cylinder, (Bearing Ø 85mm)	1

composed of:

1	KL-0040-2500	Hydraulic Cylinder (17t)	1
-	KL-0041-450 B	Wheel Bearing Tool Kit, without 17t Hydraulic Cylinder, (Bearing Ø 85mm)	1

Pos.	Part No.	Description	Qty
-	KL-0041-450 B	Wheel Bearing Tool Kit, without 17t Hydraulic Cylinder, (Bearing Ø 85mm)	1

composed of:

2	KL-0039-1003	Retaining Adaptor with O-Rings, for Hydraulic Cylinder	1
3	KL-0039-1002	Retaining Adaptor with O-Rings, for Clamping Nut and Pressure Spindle	1
4	KL-0039-1920-1	Pull Spindle, M20	1
5	KL-0040-3009	Clamping Nut, M20	1
-	KL-0041-451 B	Upgrade Kit , VW T5 (Bearing Ø 85mm)	1

Pos.	Part No.	Description	Qty
-	KL-0041-451 B	Upgrade Kit , VW T5 (Bearing Ø 85mm)	1

composed of:

6	KL-0039-1273	Pressure Ring, Ø 73mm	1
7	KL-0039-1283	Pressure Ring, Ø 83mm (with front axle of Touareg; Cayenne)	1
8	KL-0039-1289	Pressure Ring, Ø 89mm (with rear axle of T5)	1
9	KL-0039-1502	Pressure Ring, Ø 93mm (with front axle of T5)	1
10	KL-0041-4500 B	Clamping Shells (Pair), Ø 85mm	1
11	KL-0039-1803	Centring Sleeve, long, Ø 29.5mm	1
12	KL-0041-3931	Pressure Screw, M14x1.5	5

Accessory:

KL-0041-38 - Wheel Hub Puller, with Adjusting Spindle, 17t Hydraulic Cylinder (German Utility Model)

The **KL-0041-38** wheel hub puller allows for the quick, safe and precise removal of wheel hub bearing units and wheel hubs. Even bonded, seized or rusted wheel hub bearing units or wheel hubs are no longer an issue thanks to the hydraulic cylinder **KL-0040-2500**.

KL-0041-380 - Wheel hub puller with adjusting spindle, without hydraulic cylinder

Like the **KL-0041-38**, but supplied without the **KL-0040-2500** hydraulic cylinder and **KL-0040-2547-1** pull spindle (M20x550).

Accessory:

KL-0215-35 M25 - Hydraulic Hand Pump

The hydraulic hand pump **KL-0215-35 M25** is used with the **KL-0040-2500** hydraulic cylinder as a drive for our pulling and pressing devices.

Note: The hydraulic pressure and necessary force can be monitored while operating the pump at pressure gauge **KL-0040-2529**, (supplied with the tool set). The pressure gauge features an additional tonne scale which is precisely adapted to our **KL-0040-2500** hydraulic cylinder (17t).

Scope of Delivery (KL-0215-35 M25)

Part No.	Description	Qty
KL-0215-33	Hydraulic Hand Pump (without hose)	1
KL-0215-31	Hydraulic Hose, 1.8 m, with hose-side coupling	1
KL-0215-322	Cylinder-side coupling, 1/4"NPT	1
KL-0040-2520	Adaptor 3/8"NPT to 1/4"NPT	1
KL-0040-2529	Pressure Gauge	1

Weight: 7.5kg

Pressure max.: 700 bar