

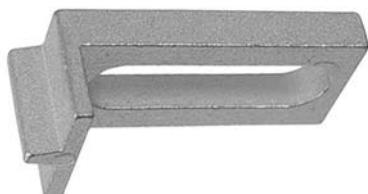

08/2018

Flywheel Locking Tool



KL-0182-17 A
KL-1380-231 A
KL-0182-19 A

EN

www.gedore-automotive.com

GEDORE Automotive GmbH

Breslauer Straße 41
78166 - Donaueschingen
Postfach 1329
78154 Donaueschingen - GERMANY

T +49 (0) 771 / 8 32 23-0
F +49 (0) 771 / 8 32 23-90
info.gam@gedore.com
www.gedore-automotive.com

GEDORE TOOLS, INC.

Only for USA, Canada & Mexico
Sólo para EE.UU., Canadá y México
Seulement pour les USA, le Canada et le Mexique

7187 Bryhawke Circle, Suite 700
North Charleston, SC 29418, USA
Phone +1-843 / 225 50 15
Fax +1-843 / 225 50 20
info@gedoretools.com

GEDORE WELTWEIT / GEDORE WORLDWIDE

Weltweite GEDORE Servicestellen / Niederlassungen finden Sie im Internet unter: www.gedore.com
Worldwide GEDORE service centers / offices are listed on the Internet at: www.gedore.com

KL-0182-17 A



Locking the flywheel

KL-0182-17 A Flywheel Locking Pin

Suitable for Citroën, Peugeot (TUD5) diesel engines e.g. on Citroën AX, Saxo, Xsara; Peugeot 106; Nissan Micra and Rover 115.

Field of Application:

Used for locking the flywheel.

KL-1380-231 A

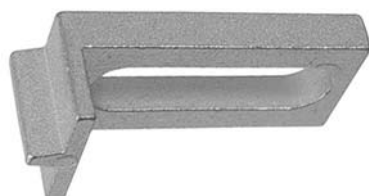

KL-1380-231 A Flywheel Locking Tool

Suitable for Citroën, Peugeot diesel and petrol engines.

Field of Application:

Used for locking the flywheel.

KL-0182-19 A



KL-0182-19 A Flywheel Locking Tool

Suitable for Renault 2.2 L diesel engines (G8T) e.g. on Renault Laguna, Safrane and Espace.

Field of Application:

For locking the flywheel when the gearbox has been removed from the vehicle.

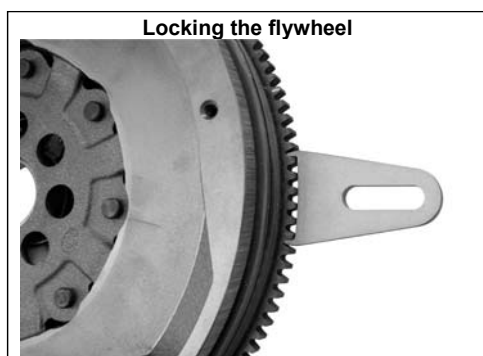

Warnings and Notes

- Do not attempt to start the engine whilst the locking tools are still installed.
- Any work on vehicles should only be performed by qualified personnel observing and complying with the directions, provisions, and safety regulations issued by the vehicle manufacturer.
- Only the vehicle manufacturer's data apply to all work done on the vehicle.
- All specific vehicle data stated herein are supplied under reserve and without commitment.