

GEDORE

TOOLS FOR LIFE

Counter-Holding Tools

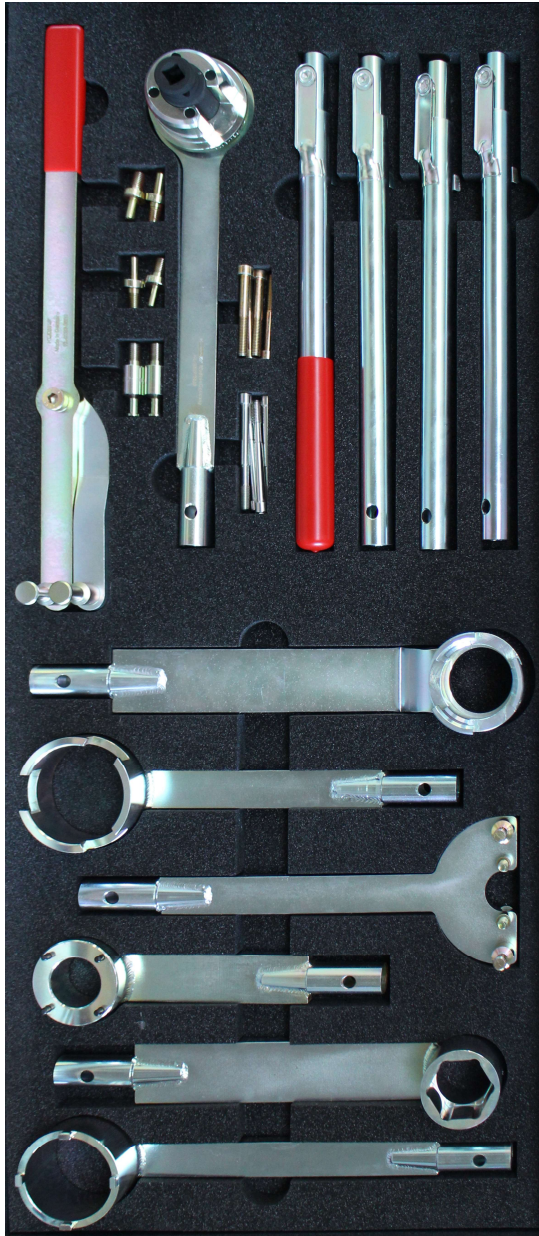

KL-0184-..Series
KL-0282-35 B

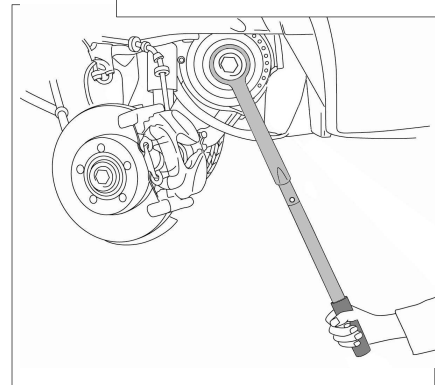
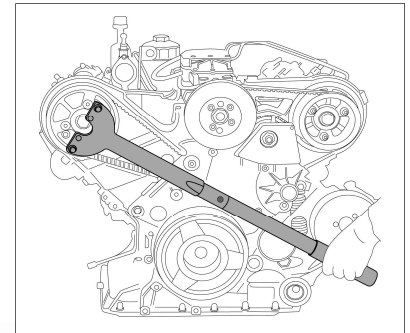

0184-..Serie_EN220111

GEDORE Automotive GmbH

Breslauer Straße 41
78166 Donaueschingen

Postfach 1329
78154 Donaueschingen - GERMANY

Phone: +49 (0) 771 / 8 32 23-0
Fax: +49 (0) 771 / 8 32 23-90

Email: info@gedore-automotive.com
Internet: www.gedore-automotive.com

1. Product Description

2.1 KL-0184-..Series - Counter-Holding Tools

Technical Data

Length of the extension tube: 400mm
 Length of the handle: 403mm

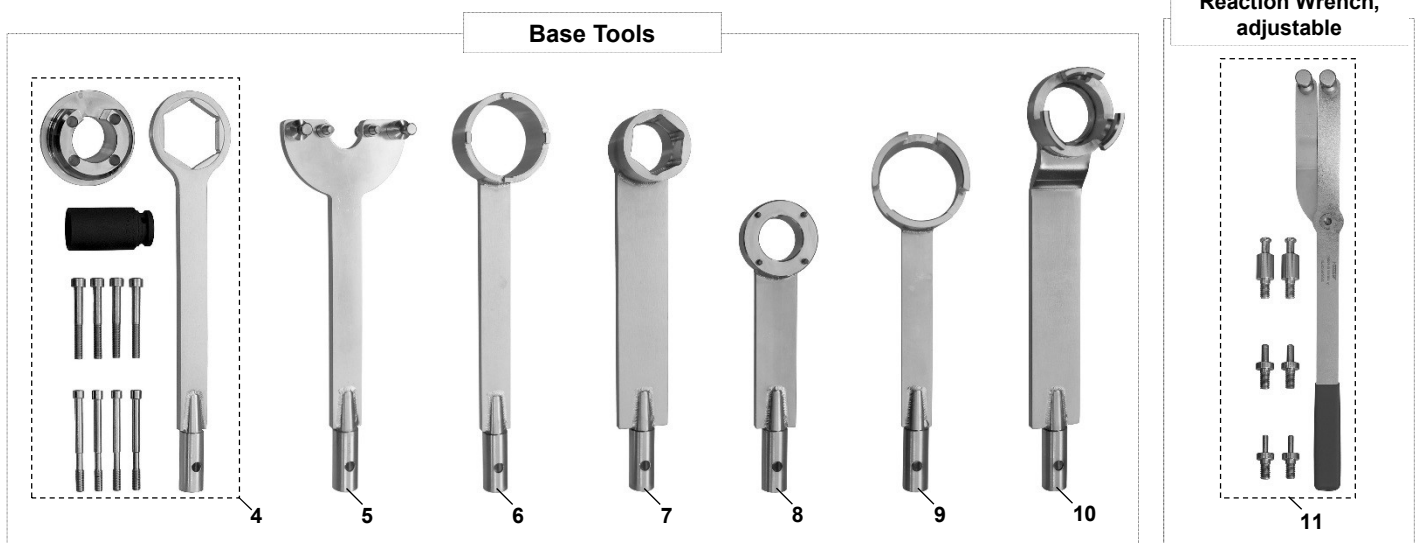
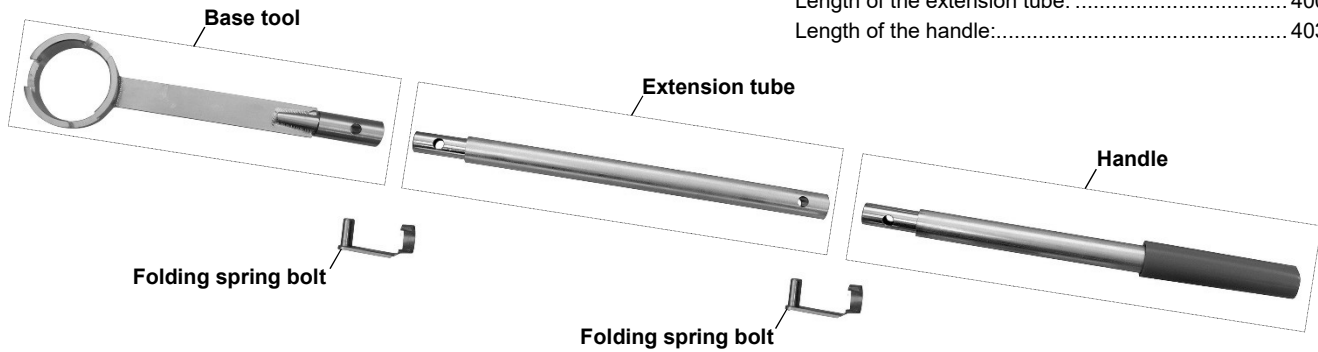

Application Table/Compositions of Counter-Holding Tools

Required Tool Components:					Field of Application*		Product Information
Pos.	Base tool	Extension tube	Handle	Folding spring bolt	For counter-holding the...	Applicable to...	Use as per instructions ...
4	KL-0184-0210 Base Tool, VW	3x	1x	4x	crankshaft pulley	VW-Audi 2.4 and 2.5, 4-cylinder as well as 5-cylinder Diesel engines, both with and without vibration damper.	KL-0184-021 Page 4-5
5	KL-0184-0220 Base Tool, VW	-	1x	1x	crankshaft pulley, timing belt sprocket etc.	Universally applicable to VW-Audi, Seat and Skoda 1.2; 1.4 and 1.6 petrol engines, as well as 1.9 SDI Diesel engines.	KL-0184-022 Page 6
6	KL-0184-0230 Base Tool, VW	-	1x	1x	crankshaft pulley	VW 1.4 and 1.6 16V petrol engines.	KL-0184-023 Page 7
7	KL-0184-0240 Base Tool, VW	1x	1x	2x	crankshaft pulley	VW-Audi, Seat and Ford Galaxy fitted with a 2.3, 2.8, 3.2, 3.6, 4.0 or 6.0 engine.	KL-0184-024 Page 8
8	KL-0184-0250 Base Tool, VW	1x	1x	2x	crankshaft vibration damper	VW-Audi, Seat, Skoda fitted with a 1.8 or 2.0 TSI/TFSI engine.	KL-0184-025 Page 9
9	KL-0184-0410 Base Tool, Opel/Vauxhall	-	1x	1x	crankshaft pulley	Opel/Vauxhall 2.2 16V TwinCam petrol engines.	KL-0184-041 Page 10
10	KL-0184-0610 Base Tool, Ford	-	1x	1x	crankshaft pulley	Ford, Mazda, Volvo 1.3, 1.5, 1.8, 2.0 and 2.3 engines.	KL-0184-061 Page 11
11	KL-0282-35 B Reaction Wrench, adjustable	Complete tool			timing belt sprocket	Universally applicable to VW-Audi, Seat, Skoda, Alfa, Fiat, Lancia, Dacia, MG, Nissan, Ford, Opel/Vauxhall, Peugeot, Renault, Citroën, Rover, Volvo, Suzuki, Isuzu, Japanese vehicles, etc.	KL-0282-35 B Page 12

* For more detailed information on the field of application, please see respective pages ...

KL-0184-011 E

Universal



Scope of Delivery:

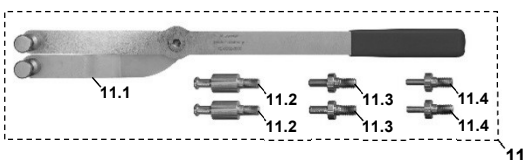
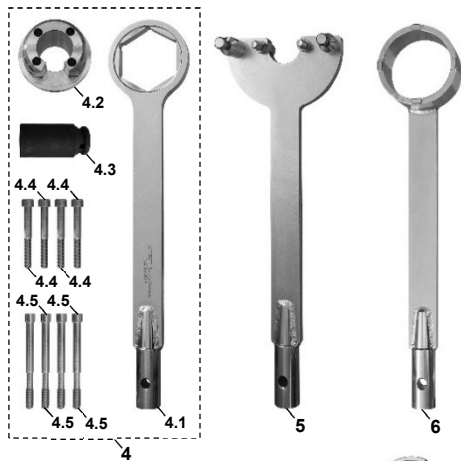
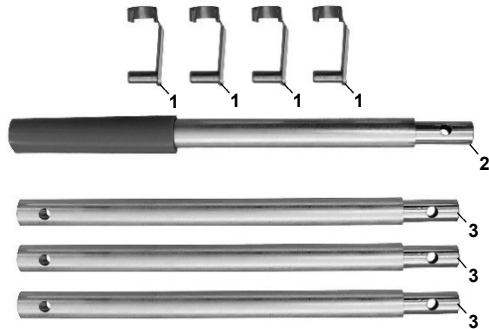

KL-0184-011 E - Counter-Holding Tool Kit, in a Foam Insert

Universally applicable; e.g. to: VW-Audi, Seat, Skoda 1.2, 1.4, 1.6, 1.8, 2.0, 2.3, 2.4, 2.5, 2.8, 3.2, 3.6, 4.0, 6.0; Opel/Vauxhall, Fiat, Alfa Romeo 2.2 16V and Ford, Mazda, Volvo 1.3, 1.5, 1.6, 1.8, 2.0, 2.3 petrol and Diesel engines respectively.

(Engine codes: VW-Audi, Seat, Skoda: AFK, AGZ, AHW, AJA, APE, AQN, AQQ, ARC, ARR, ASY, ATN, AUA, AUB, AUE, AUS, AVY, AWY, AXP, AXU, AXZ, AYL, AYT, AZD, AZQ, AZZ, BAA, BAD, BAG, BAN, BAP, BBM, BBY, BBZ, BCA, BCB, BDB, BDE, BDL, BDM, BDN, BDP, BFH, BHE, BHK, BHL, BHT, BJJ, BJK, BJL, BJM, BJN, BJS, BKG, BKJ, BKK, BKL, BKY, BKY, BLF, BLG, BLN, BLP, BMD, BME, BMJ, BML, BMV, BMX, BMY, BRJ, BRK, BRN, BRP, BSB, BTE, BTS, BTT, BUB, BUD, BUD, BWK, BWS, BXW, BYT, BZB, BZG, CABA, CABB, CABD, CAVA, CAVB, CAVC, CAVD, CAVE, CAVF, CAVG, CAWA, CAWB, CAXA, CAXC, CBFA, CBRA, CBZA, CBZB, CCTA, CCZA, CCZB, CCZC, CDAA, CDAB, CDGA, CDHA, CDHB, CDNB, CDNC, CDND, CEBA, CEBB, CECA, CECB, CESA, CETA, CFKA, CGGA, CGGB, CGPA, CGPB, CGYA, CHFA, CHFB, CKMA, CMAA // Opel/Vauxhall, Fiat, Alfa Romeo: Z22SE, Z22YH, 194A1.000, 939 A5.000 // Ford, Mazda, Volvo: B4184S11, B4184S8, B4204S3, B4204S4, L3 Turbo, LF, LF (MZR DISI), MZ-CD 1.6 (Y6), MZR 1.3 (ZJ), MZR 1.5 (ZY), MZR 1.8 (L8), MZR 2.0 (LF), ZJ, ZY)

Field of Application

The **KL-0184-011 E** counter-holding tool kit is needed to counter-hold crankshaft pulleys, as well as timing belt and crankshaft sprockets while loosening/tightening the crankshaft or camshaft central screw.

The special **KL-0184-0119** foam insert is designed to keep the tools of the **KL-0184-011 E** counter-holding tool kit always properly organised and well protected in the **KL-4999-121** workshop trolley.

Thanks to this ingenious tool management system, tools can be found quickly and easily and missing tools identified at a glance. As a result, repairs can be carried out more efficiently - saving you time and money.

The foam inserts are provided with specifically tool-shaped spaces to ensure that tools are safely stored and can be taken out and put back in place with ease.

Scope of Delivery

Pos.	Part No.	Description	Qty
-	KL-0184-011 E	Counter-Holding Tool Kit, in a Foam Insert	1
<i>composed of:</i>			
1	KL-0184-0103	Folding Spring Bolt	4
2	KL-0184-0101	Extension Tube with Protective Handle	1
3	KL-0184-0102	Extension Tube	3
4	KL-0184-0210	Counter-Holding Tool (Base Tool)	1
5	KL-0184-0220	Counter-Holding Tool (Base Tool)	1
6	KL-0184-0230	Counter-Holding Tool (Base Tool)	1
7	KL-0184-0240	Counter-Holding Tool (Base Tool)	1
8	KL-0184-0250	Counter-Holding Tool (Base Tool)	1
9	KL-0184-0410	Reaction Wrench (Base Tool)	1
10	KL-0184-0610	Reaction Wrench (Base Tool)	1
11	KL-0282-35 B	Reaction Wrench Set (adjustable)	1
-	KL-0184-0119	Foam Insert (without tools)	1

Pos.	Part No.	Description	Qty
4	KL-0184-0210	Counter-Holding Tool (Base Tool)	1
<i>composed of:</i>			
4.1	KL-0184-0211	Counter-Holding Tool (Base Tool)	1
4.2	KL-0284-6101	Adaptor	1
4.3	KL-0284-62	Hex Socket	1
4.4	KL-0284-6106	Cheese Head Screw, M8x65	4
4.5	KL-0284-6102	Special Cheese Head Screw	4

Pos.	Part No.	Description	Qty
11	KL-0282-35 B	Reaction Wrench Set (adjustable)	1
<i>composed of:</i>			
11.1	KL-0282-35	Reaction Wrench (adjustable)	1
11.2	KL-0282-311	Set of Pins, Ø 18mm	1
11.3	KL-0282-312	Set of Pins, Ø 7.5mm	1
11.4	KL-0282-313	Set of Pins, Ø 6mm	1

KL-0184-021



Abb. 1: Unscrew the vibration damper fastening screws.



Abb. 2: Mount adaptor "4.3" to vibration damper.



Abb. 3: Position reaction wrench.

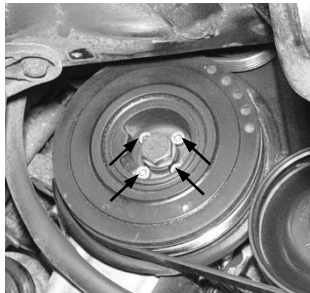

KL-0184-021 - Counter-Holding Tool, VW

Suitable for use on VW-Audi 2.4 and 2.5litre 4- and 5-cylinder engines, both with and without vibration damper as found on VW Crafter, T4.

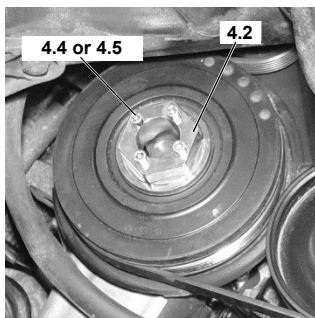
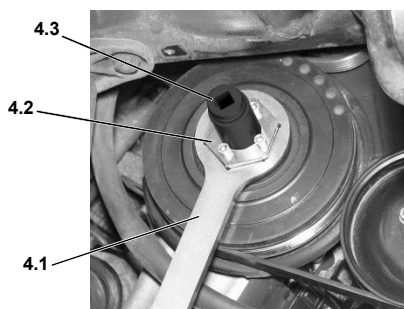
Engine codes: AJA, BJJ, BJK, B JL, BJM, CEBA, CEBB, CECA, CECB)

Field of Application

This tool is designed to counter-hold the crankshaft pulley while loosening or tightening the crankshaft central screw.

Indispensable when replacing timing belts, sealing rings or flywheels, as well as during engine repairs.

Technical Data

Overall length (of the assembled tool):..... 1800mm
 Length of base tool "4.1":..... 401mm
 Drive of hex socket "4.3": 1/2" □

Scope of Delivery

Pos.	Part No.	Description	Qty
-	KL-0184-021	Counter-Holding Tool, VW	1
<i>composed of:</i>			
-	KL-0184-0210	Counter-Holding Tool, Base Tool with Adaptor	1
1	KL-0184-0103	Folding Spring Bolt	4
2	KL-0184-0101	Extension Tube with Protective Handle	1
3	KL-0184-0102	Extension Tube	3
Pos.	Part No.	Description	Qty
4	KL-0184-0210	Counter-Holding Tool, Base Tool with Adaptor	1
<i>composed of:</i>			
4.1	KL-0184-0211	Counter-Holding Tool (Base Tool)	1
4.2	KL-0284-6101	Adaptor	1
4.3	KL-0284-62	Hex Socket	1
4.4	KL-0284-6106	Cheese Head Screw, M8x65mm	4
4.5	KL-0284-6102	Special Cheese Head Screw	4

Warnings and Notes

- Do not attempt to start the engine whilst the KL-0184-021 counter-holding tool is still mounted.
- Any work on vehicles should only be performed by qualified specialist personnel observing and complying with the directions, provisions, and safety regulations specified by the vehicle manufacturer.
- Always refer to the vehicle manufacturer's data and instructions as only these apply to all work that is carried out on the vehicle.
- All vehicle-specific data stated herein are supplied under reserve and without commitment.

Example of Use:

- Assemble tool by mounting extension tube with protective handle "2" and 3x extension tubes "3" to base tool "4.1". Secure with folding spring bolts "1".
- Unscrew the vibration damper fastening screws. (Fig. 1)
- Attach adaptor "4.2" to vibration damper with cheese head screws "4.4" or "4.5" respectively as shown in Fig. 2.
- Place counter-holding tool "4.1" onto adaptor "4.2". (Fig. 3)
Note: With VW T4 or Crafter vehicles, use hex socket "4.3" to loosen and tighten the crankshaft central screw.

Abb. 4: Loosen crankshaft central screw.



Abb. 5: Tighten crankshaft central screw.



Accessory: KL-4007-311

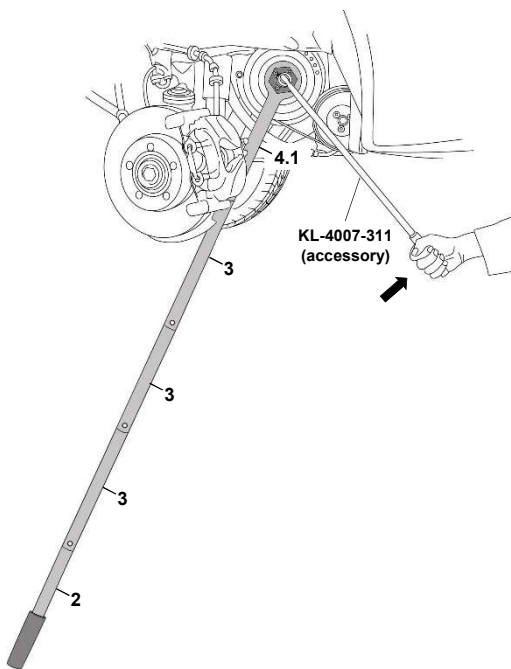
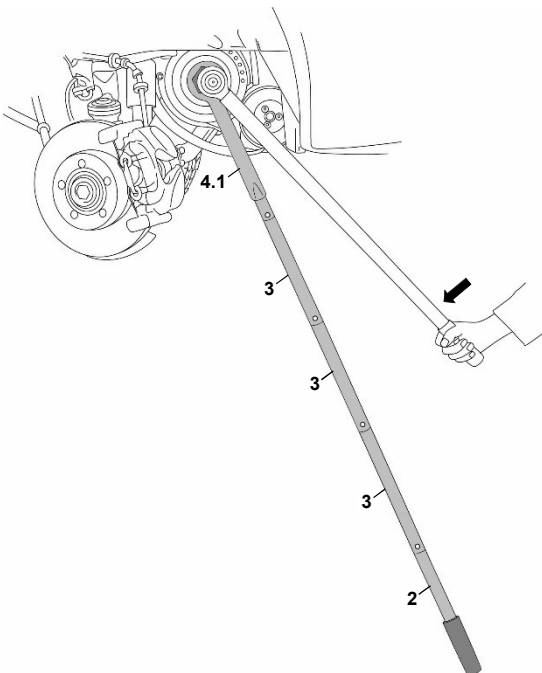

Accessory: KL-0282-51

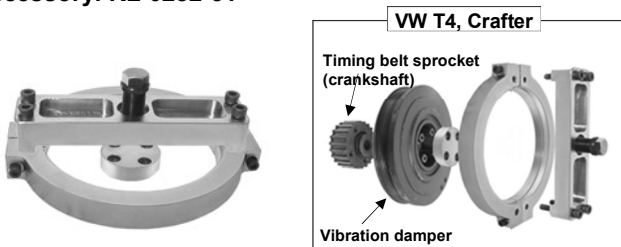

5. Support counter-holding tool by positioning extension tube with handle "2" on workshop floor as shown in **Fig. 4**.
Loosen crankshaft central screw, for example, with the aid of **KL-4007-311** swivel head breaker bar (accessory).

6. Support counter-holding tool by positioning extension tube with handle "2" on workshop floor as shown in **Fig. 5**.
Tighten crankshaft central screw using a suitable torque wrench.

Note: Always observe the specified torque!

Accessories

KL-4007-311 - Swivel Head Breaker Bar, 1/2", Length 620mm

Ultra-long design, with 180° swivel head.

Designed for extremely stubborn fastenings screws.

Technical Data:

Overall length:..... 620mm

Drive: 1/2" □

Maximum load capacity: 512Nm

KL-0282-51 - Puller for Vibration Damper

Suitable for the VW 5-cylinder engines with ribbed V-belt; e.g. in T4, LT etc.

Designed for the removal of the vibration damper with the timing belt sprocket being pushed back at the same time. This puller is absolutely indispensable if the shoulder of the crankshaft timing belt sprocket is seized up in the vibration damper.

The tool can also be used with the engine installed in the vehicle.

KL-0184-022



Example of use: KL-0184-022

Use with pins

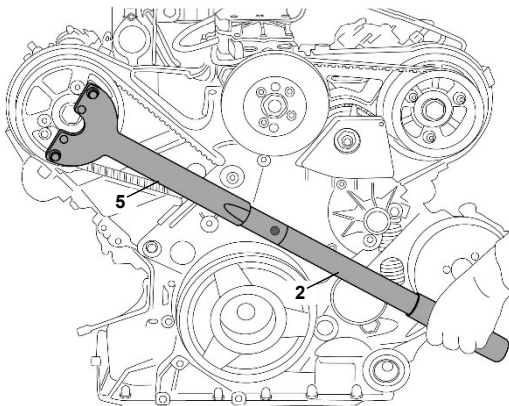

Use with bolts

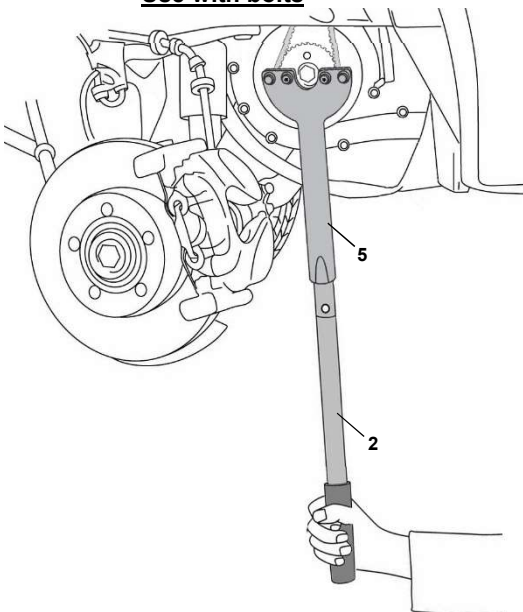

KL-0184-022 - Counter-Holding Tool, VW

Universal application.

Essential tool for VW-Audi, Seat and Skoda 1.2, 1.4 and 1.6 petrol engines with 2- or 4-valve technology, as well as for Skoda 1.9 SDI Diesel engines. Fitted to: VW Beetle, Bora, Caddy/Caddy Maxi, Eos, Fox, Golf, Golf Plus, Golf VI Cabrio, Jetta, Lupo, Passat, Polo, Scirocco, Sharan, Tiguan, Touran; Audi A1, A2, A3, A3 Convertible; Seat Alhambra, Altea/Altea XL, Arosa, Cordoba, Ibiza, Inca, Leon, Toledo; Skoda Fabia, Fabia II, Octavia II, Octavia/Octavia Tour, Praktik, Roomster, Superb II, Yeti.

Engine codes: AFK, AHW, APE, AQQ, ARR, ASY, AUA, AUB, AUS, AVY, AWY, AXP, AXU, AZD, AZQ, BAD, BAG, BBM, BBY, BBZ, BCA, BCB, BKG, BKY, BLF, BLG, BLN, BLP, BMD, BME, BMY, BTS, BUD, BWK, BXW, BZG, CAVA, CAVB, CAVC, CAVD, CAVE, CAVF, CAVG, CAXA, CAXC, CBZA, CBZB, CDGA, CGGA, CGGB, CGPA, CGPB, CHFA, CHFB, CKMA, CMAA)

Field of Application

This tool is designed to counter-hold pulleys, timing belt sprockets etc. It is required when loosening/tightening the fastening screw.

The locking takes place either via the pins (Ø 11.5mm) which engage the holes of the pulleys/timing belt sprockets, or by fixing the counter-holding tool to the crankshaft timing belt sprocket by means of the M8 bolts.

Thanks to its special length of 704mm, this tool allows even very tight-fitting or stubborn fastening screws to be loosened with ease.

Technical Data

Overall length (of the assembled tool):	704mm
Length of the base tool "5":	351mm
Pin Ø:	11.5mm
Pin pitch:	99.5mm
Pin height:	31.5mm
Bolt thread:	M8
Bolt pitch:	45.5mm
Bolt height:	18mm

Scope of Delivery

Pos.	Part No.	Description	Qty
-	KL-0184-022	Counter-Holding Tool, VW	1
composed of:			
1	KL-0184-0103	Folding Spring Bolt	1
2	KL-0184-0101	Extension Tube with Protective Handle	1
5	KL-0184-0220	Counter-Holding Tool Base Tool with Bolts	1

Warnings and Notes

- Do not attempt to start the engine whilst the KL-0184-022 counter-holding tool is still installed.
- Any work on vehicles should only be performed by qualified specialist personnel observing and complying with the directions, provisions, and safety regulations specified by the vehicle manufacturer.
- Always refer to the vehicle manufacturer's data and instructions as only these apply to all work that is carried out on the vehicle.
- All vehicle-specific data stated herein are supplied under reserve and without commitment.

KL-0184-023

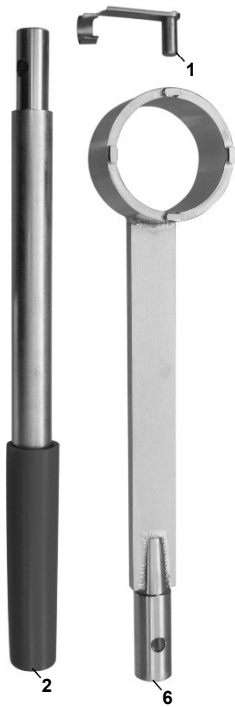

Example of use: KL-0184-023

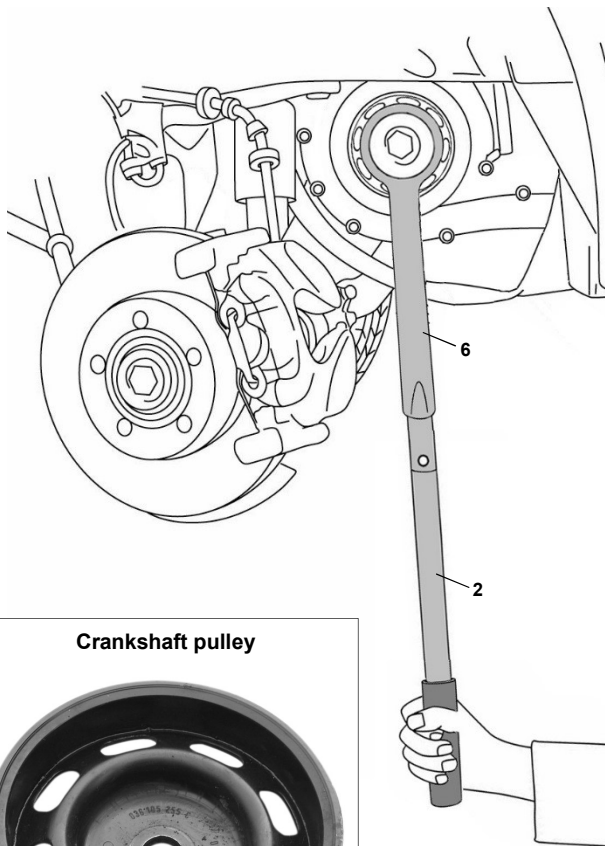

KL-0184-023 - Counter-Holding Tool, VW

Suitable for the VW 1.4 and 1.6 16V petrol engines.

Fitted to VW Beetle, Bora, Caddy/Caddy Maxi, Golf, Lupo, Polo.

(Engine codes: AHW, APE, AQQ, ARC, ARR, ATN, AUA, AUB, AUS, AVY, AZD, BBY, BBZ, BCA, BCB, BKY, BUD)

Field of Application

This tool is used to counter-hold the crankshaft pulley while loosening and tightening the crankshaft central screw.

Technical Data

Overall length (of the assembled tool):..... 739mm

Length of the base tool "6": 386mm

Scope of Delivery

Pos.	Part No.	Description	Qty
-	KL-0184-023	Counter-Holding Tool, VW	1
<i>composed of:</i>			
1	KL-0184-0103	Folding Spring Bolt	1
2	KL-0184-0101	Extension Tube with Protective Handle	1
6	KL-0184-0230	Counter-Holding Tool (Base Tool)	1

Warnings and Notes

- Do not attempt to start the engine whilst the **KL-0184-023** counter-holding tool is still installed.
- Any work on vehicles should only be performed by qualified specialist personnel observing and complying with the directions, provisions, and safety regulations specified by the vehicle manufacturer.
- Always refer to the vehicle manufacturer's data and instructions as only these apply to all work that is carried out on the vehicle.
- All vehicle-specific data stated herein are supplied under reserve and without commitment.

KL-0184-024



Example of use: KL-0184-024

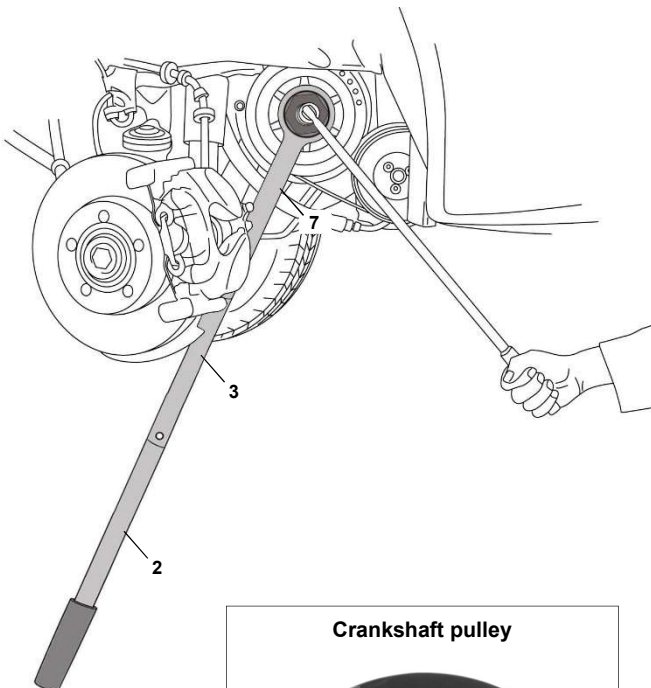

KL-0184-024 - Counter-Holding Tool, VW

Applicable to VW-Audi, Seat vehicles and Ford Galaxy equipped with either a 2.3, 2.8, 3.2, 3.6, 4.0 or 6.0 engine;

such as: VW Beetle, Bora, Sharan, Eos, Golf, Touareg, Transporter T5, Passat CC, Passat, Phaeton; Audi A3, A8, Q7, TT; Seat Alhambra, Leon, Toledo; Ford Galaxy.

(Engine codes: AGZ, AQN, AUE, AXZ, AYL, AYT, AZZ, BAA, BAN, BAP, BDB, BDE, BDL, BDM, BDN, BDP, BFH, BHE, BHK, BHL, BHT, BJN, BJS, BKJ, BKK, BKL, BMJ, BML, BMV, BMX, BRJ, BRK, BRN, BRP, BSB, BTE, BTT, BUB, BWS, CBRA)

Field of Application

This tool is used to counter-hold the crankshaft pulley while loosening and tightening the crankshaft central screw.

Technical Data

Overall length (of the assembled tool):..... 1060mm
Length of base tool "7": 361mm

Scope of Delivery

Pos.	Part No.	Description	Qty
-	KL-0184-024	Counter-Holding Tool, VW	1
<i>composed of:</i>			
1	KL-0184-0103	Folding Spring Bolt	2
2	KL-0184-0101	Extension Tube with Protective Handle	1
3	KL-0184-0102	Extension Tube	1
7	KL-0184-0240	Counter-Holding Tool (Base Tool)	1

Warnings and Notes

- Do not attempt to start the engine whilst the **KL-0184-024** counter-holding tool is still mounted.
- Any work on vehicles should only be performed by qualified specialist personnel observing and complying with the directions, provisions, and safety regulations specified by the vehicle manufacturer.
- Always refer to the vehicle manufacturer's data and instructions as only these apply to all work that is carried out on the vehicle.
- All vehicle-specific data stated herein are supplied under reserve and without commitment.

KL-0184-025



Example of use: KL-0184-025

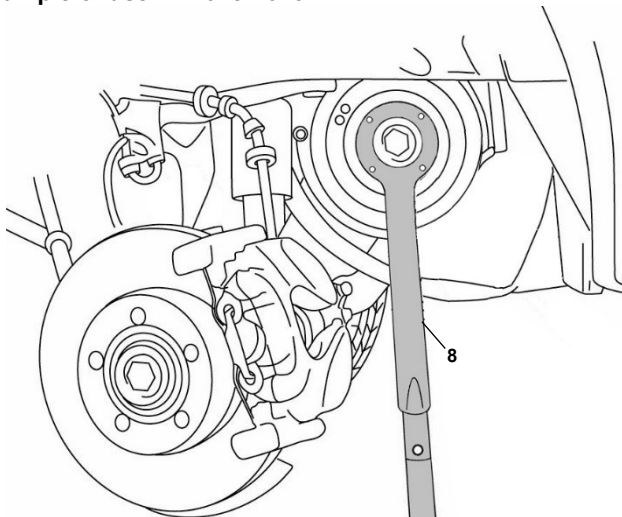

Crankshaft pulley

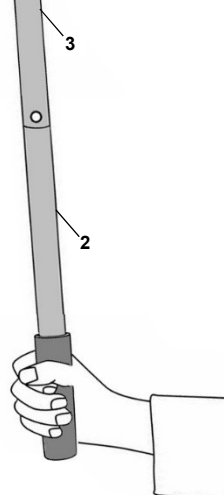
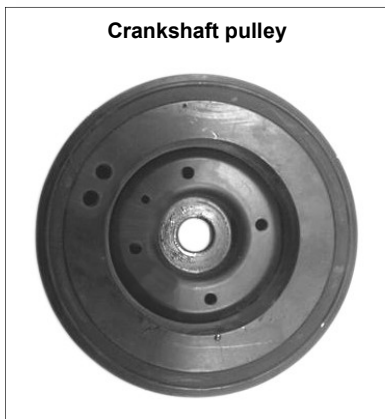

KL-0184-025 - Counter-Holding Tool, VW

Suitable for VW-Audi, Seat, Skoda vehicles equipped with either a 1.8 or 2.0 TSI / TFSI engine;

such as: VW Golf, Eos, Jetta, Passat, Passat CC, Scirocco, Sharan, Tiguan; Audi A3, A4, A5, Q5, TT; Seat Toledo, Altea/Altea XL, Exeo, Leon; Skoda Octavia II, Superb II, Yeti.

(Engine codes: BYT, BZB, CABA, CABB, CABD, CAWA, CAWB, CBFA, CCTA, CCZA, CCZB, CCZC, CDA, CDAB, CDHA, CDHB, CDNB, CDNC, CDND, GESA, CETA, CFKA, CGYA).

Field of Application

This tool is used to counter-hold the vibration damper while loosening and tightening the crankshaft central screw.

Technical Data

Overall length (of the assembled tool): 980mm
 Length of base tool "8": 276mm

Scope of Delivery

Pos.	Part No.	Description	Qty
-	KL-0184-025	Counter-Holding Tool, VW	1
<i>composed of:</i>			
1	KL-0184-0103	Folding Spring Bolt	2
2	KL-0184-0101	Extension Tube with Protective Handle	1
3	KL-0184-0102	Extension Tube	1
8	KL-0184-0250	Counter-Holding Tool, Base Tool with Pins	1

Warnings and Notes

- Do not attempt to start the engine whilst the KL-0184-025 counter-holding tool is still mounted.
- Any work on vehicles should only be performed by qualified specialist personnel observing and complying with the directions, provisions, and safety regulations specified by the vehicle manufacturer.
- Always refer to the vehicle manufacturer's data and instructions as only these apply to all work that is carried out on the vehicle.
- All vehicle-specific data stated herein are supplied under reserve and without commitment.

KL-0184-041



**KL-0184-041 - Reaction Wrench,
Opel/Vauxhall**

Suitable for Opel/Vauxhall TwinCam (DOHC) 2.2 16V petrol engines.

Fitted to Opel/Vauxhall Astra-G, Astra-H, Signum, Vectra-B, Vectra-C, Speedster, Zafira-A, Zafira-B; Fiat Croma

(Engine codes: Z22SE, Z22YH, 194A1.000); Alfa Romeo 159 (939) 2.2 JTS (Engine code: MKB 939 A5.000).

Field of Application

This tool is designed to counter-hold the crankshaft pulley while loosening and tightening the crankshaft central screw.

Technical Data

Overall length (of the assembled tool): 694mm
Length of base tool "9": 341mm

Example of use: KL-0184-041

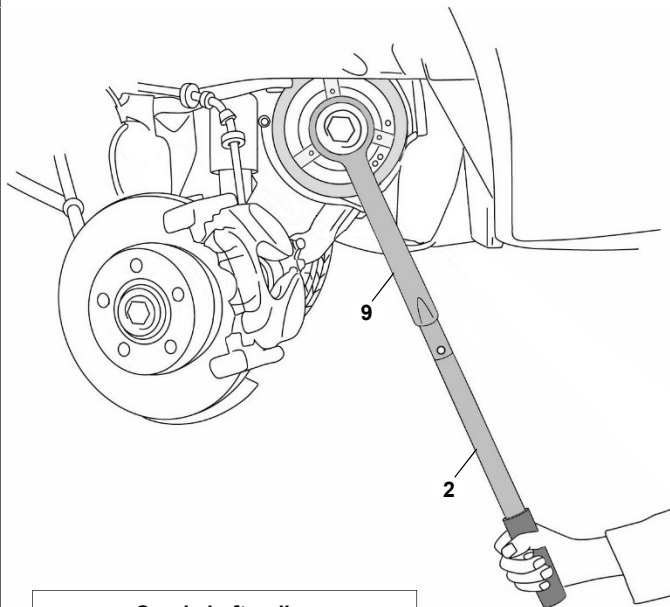

Crankshaft pulley

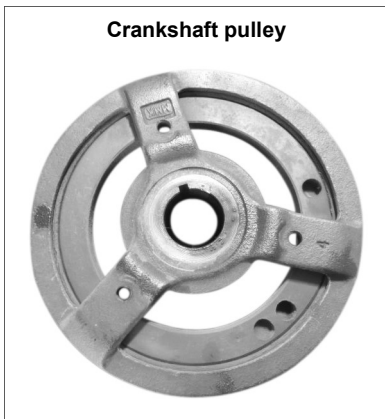

Scope of Delivery

Pos.	Part No.	Description	Qty
-	KL-0184-041	Reaction Wrench, Opel/Vauxhall	1
<i>composed of:</i>			
1	KL-0184-0103	Folding Spring Bolt	1
2	KL-0184-0101	Extension Tube with Protective Handle	1
9	KL-0184-0410	Reaction Wrench (Base Tool)	1

⚠ Warnings and Notes

- Do not attempt to start the engine whilst the **KL-0184-041** reaction wrench is still mounted.
- Any work on vehicles should only be performed by qualified specialist personnel observing and complying with the directions, provisions, and safety regulations specified by the vehicle manufacturer.
- Always refer to the vehicle manufacturer's data and instructions as only these apply to all work that is carried out on the vehicle.
- All vehicle-specific data stated herein are supplied under reserve and without commitment.

KL-0184-061



Example of use: KL-0184-061

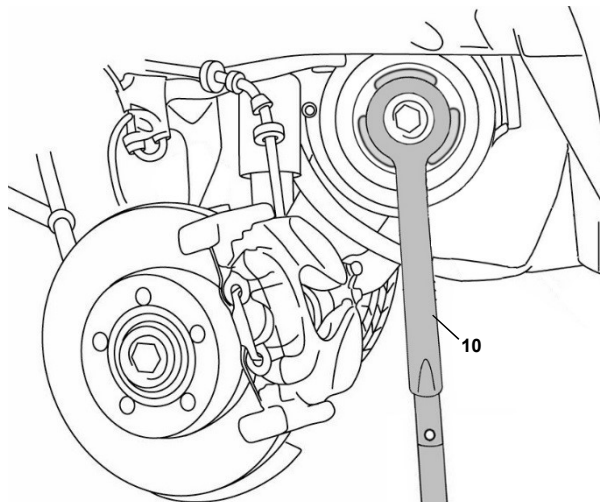

Crankshaft pulley

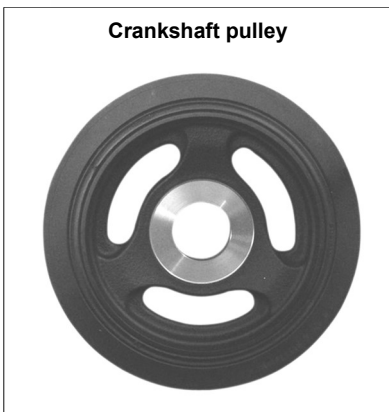

KL-0184-061 - Reaction Wrench, Ford

Suitable for Ford, Mazda, Volvo 1.3, 1.5, 1.6, 1.8, 2.0 and 2.3 litre engines.

Fitted to Ford Focus/C-Max, Mondeo, S-Max, Galaxy; Mazda 2, 3, 5, 6, CX-7, MX-5; Volvo C30, S40, V50, V70, S80.

(Engine codes: B4184S11, B4184S8, B4204S3, B4204S4, L3 Turbo, LF, LF (MZR DISI), MZ-CD 1.6 (Y6), MZR 1.3 (ZJ), MZR 1.5 (ZY), MZR 1.8 (L8), MZR 2.0 (LF), ZJ, ZY)

Field of Application

This tool is designed to counter-hold the crankshaft pulley while loosening and tightening the crankshaft central screw. It is required when replacing timing belts or for engine repairs.

Technical Data

Overall length (of the assembled tool): 754mm
Length of base tool "10": 401mm

Scope of Delivery

Pos.	Part No.	Description	Qty
-	KL-0184-061	Reaction Wrench, Ford	1
<i>composed of:</i>			
1	KL-0184-0103	Folding Spring Bolt	1
2	KL-0184-0101	Extension Tube with Protective Handle	1
10	KL-0184-0610	Reaction Wrench (Base Tool)	1

Warnings and Notes

- Do not attempt to start the engine whilst the **KL-0184-061** reaction wrench is still mounted.
- Any work on vehicles should only be performed by qualified specialist personnel observing and complying with the directions, provisions, and safety regulations specified by the vehicle manufacturer.
- Always refer to the vehicle manufacturer's data and instructions as only these apply to all work that is carried out on the vehicle.
- All vehicle-specific data stated herein are supplied under reserve and without commitment.
- The **KL-0184-061** reaction wrench is only designed to counter-hold the crankshaft pulley while loosening or tightening the crankshaft central screw.

KL-0282-35 B

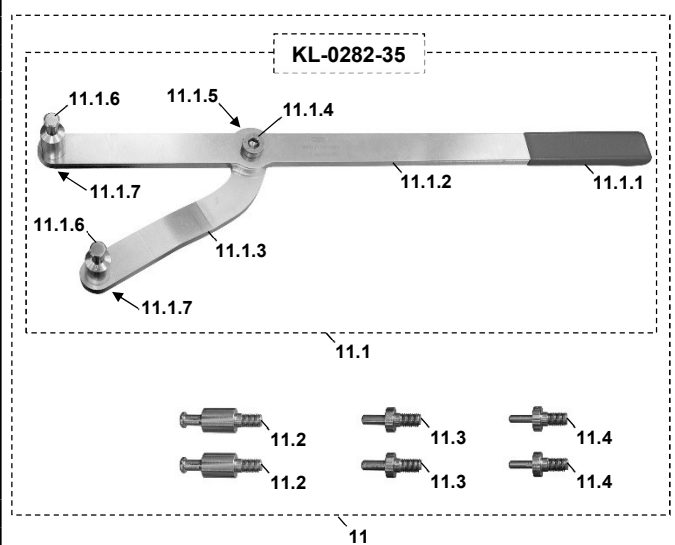

Example of use:

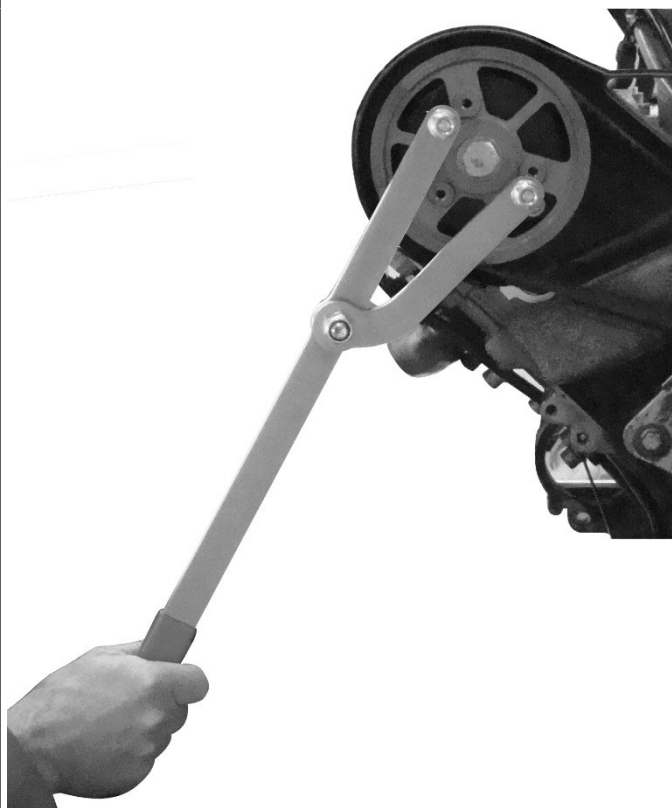

KL-0282-35 B - Reaction Wrench Set (470mm long, adjustable)

Universally suitable for the perforated timing belt sprockets with hole \varnothing not smaller than 6.5mm as found in: VW-Audi, Seat, Skoda, Alfa, Fiat, Lancia, Dacia, MG, Nissan, Ford, Opel/Vauxhall, Peugeot, Renault, Citroën, Rover, Volvo, Suzuki, Isuzu, Japanese vehicles, etc.

Field of Application

Designed to prevent timing belt sprockets on camshafts, injection pumps, etc. from rotating, for example, when loosening/tightening the central fastening bolt.

Thanks to the different interchangeable pins and the adjustable lever allowing for variable adjustments to hole diameters and pitches, this tool is nearly universally applicable.

Technical Data

Overall tool length:..... 470mm

Pitch between pins: from 14mm to 130mm

Pin \varnothing :..... 6mm/7.5mm/12mm/18mm

Pin height:..... 25mm/42mm

Scope of Delivery

Pos.	Part No.	Description	Qty
11	KL-0282-35 B	Reaction Wrench Set (470mm long, adjustable)	1
<i>composed of:</i>			
11.1	KL-0282-35	Reaction Wrench (adjustable)	1
11.2	KL-0282-311	Set of Pins, \varnothing 18mm (2-piece set)	1
11.3	KL-0282-312	Set of Pins, \varnothing 7.5mm (2-piece set)	1
11.4	KL-0282-313	Set of Pins, \varnothing 6mm (2-piece set)	1

Pos.	Part No.	Description	Qty
11.1	KL-0282-35	Reaction Wrench (adjustable)	1
<i>composed of:</i>			
11.1.2	KL-0282-3501	Lever	1
11.1.3	KL-0282-3502	Fork	1
11.1.4	KL-0282-3503	Cheese Head Screw, M12x30	1
11.1.5	KL-0282-3504	Hex Nut, M12	1
11.1.1	KL-1381-2004	Protective Handle, 25x8mm	1
11.1.6	KL-0282-3102	Pin, \varnothing 12mm	2
11.1.7	KL-0282-3003	Flange Nut, M10	2

⚠ Warnings and Notes

- Do not attempt to start the engine whilst the **KL-0282-35 B** reaction wrench is still mounted.
- Any work on vehicles should only be performed by qualified specialist personnel observing and complying with the directions, provisions, and safety regulations specified by the vehicle manufacturer.
- Always refer to the vehicle manufacturer's data and instructions as only these apply to all work that is carried out on the vehicle.
- All vehicle-specific data stated herein are supplied under reserve and without commitment.