



KL-0190-41 A

Release/Removal Pliers



Product information

EN

 Read and understand before use!

www.gedore-automotive.com



GEDORE Automotive GmbH

Breslauer Straße 41
78166 - Donaueschingen
Postfach 1329
78154 Donaueschingen - GERMANY

+49 (0) 771 / 8 32 23-0
+49 (0) 771 / 8 32 23-90
info.gam@gedore.com
gedore-automotive.com

GEDORE TOOLS, INC.

Only for USA, Canada & Mexico / Sólo para EE.UU., Canadá y México
Seulement pour les USA, le Canada et le Mexique
7187 Bryhawke Circle, Suite 700
North Charleston, SC 29418, USA

+1-843 / 225 50 15
+1-843 / 225 50 20
info@gedoretools.com
gedore.com

Version 05/2022

0190-41A_EN220517.indd

Product description

KL-0190-41 A - Release/Removal pliers

Fits VW-Audi 1.6 and 2.0 common rail Diesel engines. For example, installed on Audi A1 (8X), A3 (8V), A4 (B9, 8W), A5 (8F), A6 (C7, 4G), Q3 (8U), Q5 (8R), TT (FV, 8S); VW Golf VII (AU, 5G), Passat (B8, 3G), Scirocco III (13), etc.

Plastic rivets for example on the wishbone of Audi A4, A5, A6

Alternative tool: VAS 211 007, T40195

For removing press-fit injector seal rings from the cylinder head quickly and with ease. The pliers are also designed to unlock and pull out the re-usable two-part plastic body-bound rivets from door and underbody panels. The pliers head can be adjusted up to an angle of 90°, thus allowing you to work even in hard-to-reach areas.

EN



Scope of delivery/Component overview

Pos.	Part No.	Description	Qty
-	KL-0190-41 A	Release/Removal pliers	1

Technical Data

Length: 240mm



Pliers head,
90° adjustable

1: Locking/unlocking the limit stop:

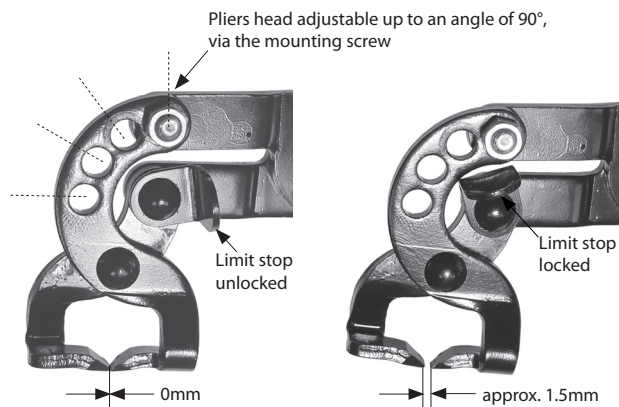

2: Removing press-fit injector seal rings from the cylinder head

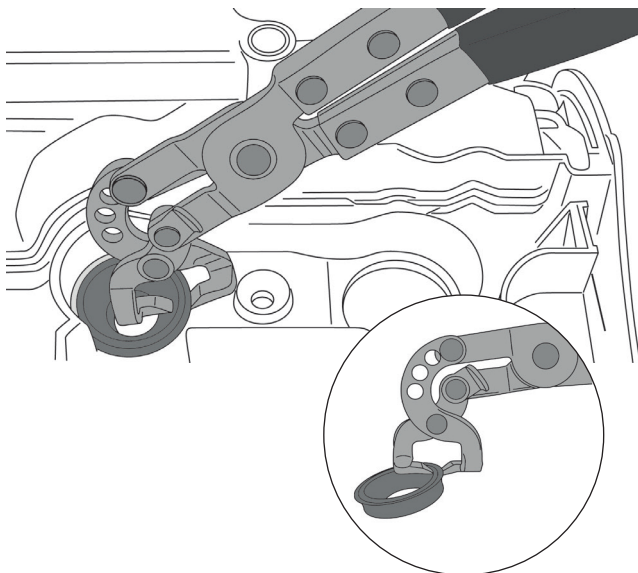

3: Pulling out the plastic body-bound rivets



Example of use

Locking/unlocking the limit stop:

Depending on application, position limit stop on release/removal pliers accordingly.

With the „**limit stop unlocked**“ position, the cutting blades of the pliers are completely closed when the pliers handles are pressed together. Required when cutting off the head from one-part plastic rivets.

With the „**limit stop locked**“ position, the cutting blades are approx. 1.5mm away from each other when the pliers handles are pressed together. Required when removing injector seals as well as to pull out the expanding pin when removing plastic body-bound rivets.

Adjusting the pliers head:

Loosen mounting screw.

Adjust pliers head as necessary (4 positions possible).

Re-insert mounting screw and tighten

! Safety instructions and regulations!

- ✔ **Before using** the special tool, read and understand **all** warning and safety instructions and **follow** them for **safe use**!
- ✔ Work on electrical installations may **only** be carried out by appropriately **qualified personnel**!
- ✔ **Always** observe and adhere to **all** safety rules and regulations when working on electrical installations!
- ✔ Use the special tool **as intended**, and **always** carry out maintenance and repair work in compliance with the regulations on occupational safety and accident prevention as well as the vehicle manufacturer's instructions!
- ✔ **Before each use**, check the special tool **carefully** for damage, loose parts, or unauthorised modifications. **Never** use it if you notice any such deficiencies!
- ✔ **Always** wear your personal protective equipment (*such as safety goggles, protective gloves, safety shoes*) during work!

GEDORE-Werkzeugfabrik GmbH & Co. KG

Remscheider Straße 149
42899 - Remscheid
Postfach 120361
47873 Remscheid
GERMANY

Vertrieb DEUTSCHLAND

☎ +49 (0) 2191 / 596-0
☎ +49 (0) 2191 / 596-230
✉ info@gedore.com
🌐 www.gedore.com

Sales INTERNATIONAL

☎ +49 (0) 2191 / 596-910
☎ +49 (0) 2191 / 596-911
✉ info@gedore.com
🌐 www.gedore.com

GEDORE TOOLS, INC.

Only for USA, Canada & Mexico
Sólo para EE.UU., Canadá y México
Seulement pour les USA, le Canada et le Mexique
7187 Bryhawke Circle, Suite 700, North Charleston, SC 29418, USA

☎ +1-843 / 225 50 15
☎ +1-843 / 225 50 20
✉ info@gedoretools.com
🌐 www.gedoretools.com

Worldwide GEDORE service centers and offices are listed on the Internet at: www.gedore.com

GEDORE Automotive GmbH

Breslauer Straße 41
78166 - Donaueschingen
Postfach 1329
78154 Donaueschingen
GERMANY

Vertrieb DEUTSCHLAND

☎ +49 (0) 771 / 8 32 23-0
☎ +49 (0) 771 / 8 32 23-90
✉ info.gam@gedore.com
🌐 gedore-automotive.com



www.gedore-automotive.com