

GEDORE

TOOLS FOR LIFE

Toothed Socket with counter nut



KL-0369-601



0369-601e140412

GEDORE Automotive GmbH

Breslauer Straße 41
78166 Donaueschingen

Postfach 1329
78154 Donaueschingen - GERMANY

Phone: +49 (0) 771 / 8 32 23-0
Fax: +49 (0) 771 / 8 32 23-90

Email: info@gedore-automotive.com
Internet: www.gedore-automotive.com

KL-0369-601



Dimensions KL-0369-601

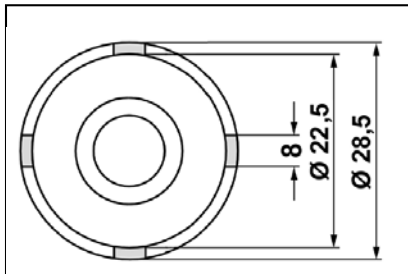

Application example:

**Pressure nut
(MAN / Mercedes)**



**KL-0369-601 Toothed Socket
with counter nut**

Suitable for MAN and Mercedes HGV engines.

Field of Application

Designed to screw / unscrew or tighten the pressure nut at the nozzle holder on MAN and Mercedes HGV engines.

By tightening the hex counter nut (with retaining thread M14x1.5 mm) on the injector, the toothed socket is prevented from slipping off.

Technical Data

Drive:	(width across flats) 32 mm
Drive (counter nut):	(width across flats) 22 mm
Length:	70 mm
Pin width:	8 mm
Pin length:	5 mm
Inner-Ø:	22.5 mm
Outer-Ø:	28.5 mm

Warnings and Notes

- Any work on engines should only be performed by qualified personnel observing and complying with the directions, provisions, and safety regulations issued by the vehicle manufacturer!
- Only the vehicle manufacturer's data apply to all work done on the vehicle.