



KL-1025-.. Series Shaft Seal Installation Tools



Product information

EN

 Read and understand before use!

www.gedore-automotive.com



GEDORE Automotive GmbH

Breslauer Straße 41
78166 - Donaueschingen
Postfach 1329
78154 Donaueschingen - GERMANY

+49 (0) 771 / 8 32 23-0
+49 (0) 771 / 8 32 23-90
info.gam@gedore.com
gedore-automotive.com

GEDORE TOOLS, INC.

Only for USA, Canada & Mexico / Sólo para EE.UU., Canadá y México
Seulement pour les USA, le Canada et le Mexique
7187 Bryhawke Circle, Suite 700
North Charleston, SC 29418, USA

+1-843 / 225 50 15
+1-843 / 225 50 20
info@gedoretools.com
gedore.com

Version 2 - 04/2022

1025-..Serie_EN220117.indd

1: KL-1025-150 / KL-1025-160 / KL-1025-180

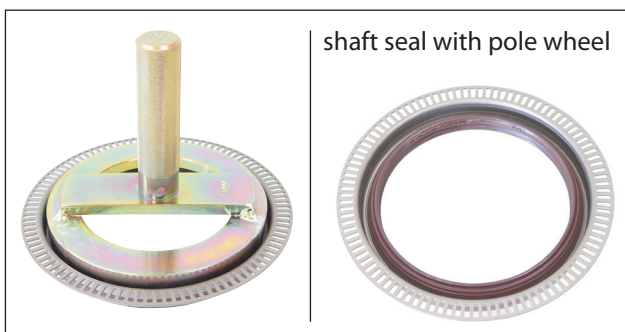
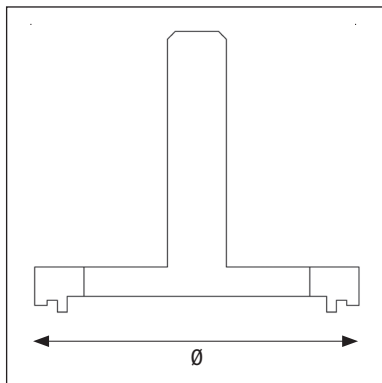

Product Description

Required for the professional installation of shaft seals, shaft seals with pole wheel respectively, as found on HGV axles and wheel hubs.

KL-1025-.. Series

KL-1025-150 - Shaft Seal Installation Tool

Applicable to Mercedes ACTROS and ATEGO, e.g. cassette seal ring in the wheel hub.

Technical Data:

Ø: 150mm

Weight: 2.100g

KL-1025-160 - Shaft Seal Installation Tool

Applicable to Mercedes ACTROS and ATEGO, e.g. shaft seal with pole wheel (MB No. A 942 334 01 15).

Technical Data:

Ø: 160mm

Weight: 2.400g

KL-1025-180 - Shaft Seal Installation Tool

Applicable to Mercedes ACTROS and ATEGO, e.g. shaft seal with pole wheel (MB No. A 020 997 05 47).

Technical Data:

Ø: 180mm

Weight: 3.900g

02: KL-1025-175 A

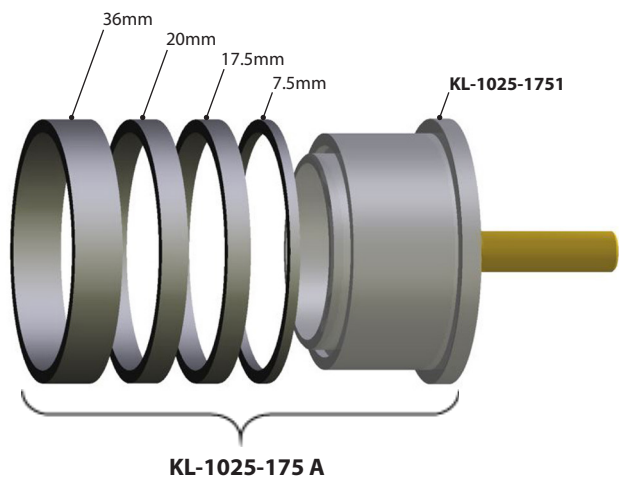
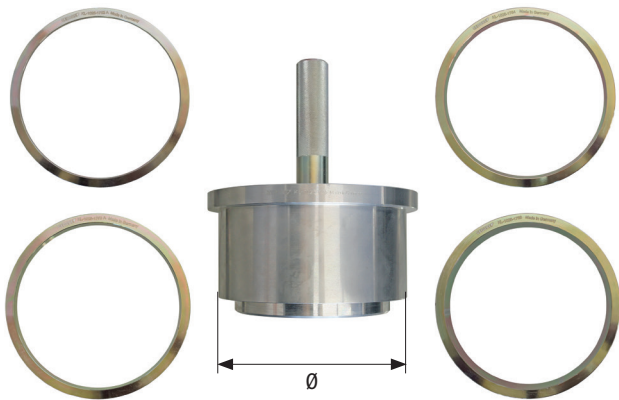

KL-1025-175 A - Shaft Seal Installation Tool, Ø 175mm

Fits Mercedes ACTROS and ATEGO rear axle shaft seal rings (including ACTROS with 11.5 t; 13 t, and 16 t AP axles).

(For example, ACTROS rear axle MB nos. - 746.217_O / - 770.001_F / - 771.0_F / - 771.1_F / - 740.8_S / - 746.210_S / - 748.2_S / - 748.7_S / - 746.213_S / - 741.71_S / - 746.21_S / - 746.301_S / - 748.59_S and ATEGO 9 t rear axle MB nos. - 770.003_F, - 770.002_F, - 770.000_F.)

Alternative tool: W 748 589 04 15 00

Notice:

- Rings **KL-1025-1752 A** and **KL-1025-1753 A** are required for rear axle series **746.21** and **748.59** with double seals.
- Rings **KL-1025-1754** and **KL-1025-1755** are required for AP axles.

Recommended Accessories:

248 ST-50 Recoilless Hammer

Technical Data:

Ø: 175mm

Weight: 8,600g

Recommended Accessories:

248 ST-50 Recoilless Hammer

Scope of Delivery/Component Overview

Part no.	Description	Qty.
KL-1025-1751	Shaft Seal Installation Tool, Ø 175mm	1
KL-1025-1752 A	Ring, 7.5mm	1
KL-1025-1753 A	Ring, 17.5mm	1
KL-1025-1754	Ring, 20mm	1
KL-1025-1755	Ring, 36mm	1

📷 2: KL-1025-105

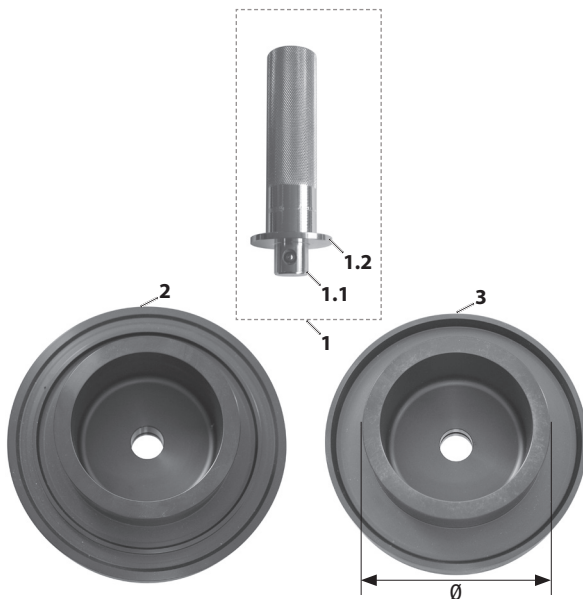

KL-1025-105 - Shaft Seal Installation Tool, Ø 105mm

Applicable to inner and outer shaft seals both with and without pole wheel as found on MAN TGA, TGM, TGS and TGX rear axles.

Alternative tools: 80.99604-0225, 80.99604-0226

The **KL-1025-105** shaft seal installation tool allows for the professional installation of both the outer shaft seal and the inner shaft seal with pole wheel at the rear axle.

Faulty mounting of the shaft seal may lead to leakage and ABS failure resulting in loss of braking power.

Recommended Accessory:

248 ST-50 Recoilless Hammer

Technical Data:

∅: 105mm

Weight: 3,000g

KL-1025-1054 - Shaft Seal Installation Tool, Ø 105mm, Outer Shaft Seal

The **KL-1025-1054** shaft seal installation tool allows for the professional installation of the outer shaft seal at the rear axle.
(Consists of: see **KL-1025-105** / Pos. 1 + 3)

KL-1025-1055 - Shaft Seal Installation Tool, Ø 105mm, Inner Shaft Seal

The **KL-1025-1055** shaft seal installation tool allows for the professional installation of the inner shaft seal with pole wheel at the rear axle.

Faulty mounting of the shaft seal may lead to leakage and ABS failure resulting in loss of braking power.

(Consists of: see **KL-1025-105** / Pos. 1 + 2)

⚠ Safety instructions and regulations

- **Before using** the special tools, read and understand all safety instructions and **follow** them for **safe use!**
- Use the special tools **as intended** and **always** carry out maintenance and repair work in compliance with the regulations on occupational safety and accident prevention as well as the vehicle manufacturer's instructions!
- **Prior to each use**, check the special tools **carefully** for damage, loose parts or unauthorised modifications. **Never** use it if you notice any such deficiencies!
- **Always** wear your personal protective equipment (for example safety goggles, protective gloves, safety shoes) when working!