



## KL-8041-300 Premium Wheel Bearing Package

**Product information** EN  
 Read and understand before use!



[www.gedore-automotive.com](http://www.gedore-automotive.com)

**GEDORE Automotive GmbH**

Breslauer Straße 41  
 78166 - Donaueschingen  
 Postfach 1329  
 78154 Donaueschingen - GERMANY

☎ +49 (0) 771 / 8 32 23-0  
 ☎ +49 (0) 771 / 8 32 23-90  
 ✉ info.gam@gedore.com  
 🌐 gedore-automotive.com

**GEDORE TOOLS, INC.**

Only for USA, Canada & Mexico / Sólo para EE.UU., Canadá y México  
 Seulement pour les USA, le Canada et le Mexique  
 7187 Bryhawke Circle, Suite 700  
 North Charleston, SC 29418, USA

☎ +1-843 / 225 50 15  
 ☎ +1-843 / 225 50 20  
 ✉ info@gedoretools.com  
 🌐 gedore.com

Version 01/2023

8041-300\_EN221015.indd

## Product description

### KL-8041-300 - Premium Wheel Bearing Package

Universal fit. Particularly suitable for VW-Audi, BMW, Ford, Seat, Škoda, Opel, etc.

The KL-8041-300 Premium Wheel Bearing Package enables the quick, precise and safe removal and installation of wheel bearings, wheel hubs, stub axles and cardan shafts. Even badly stuck or rusted wheel bearings can be easily pulled out with the hydraulic cylinder.

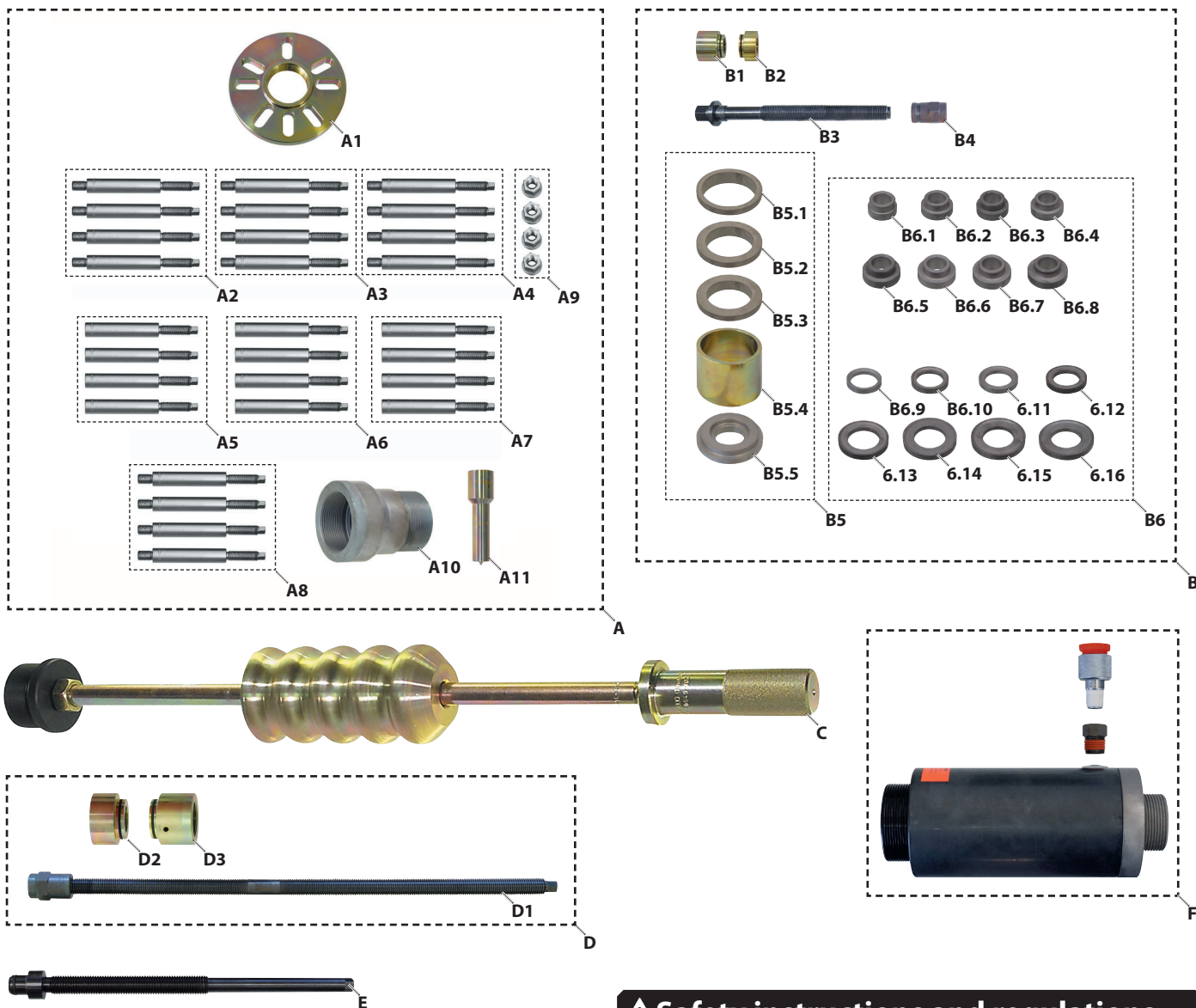

### ⚠ Safety instructions and regulations

- **Before using** the special tools, read and understand all safety instructions and follow them for **safe use!**
- Use the special tools **as intended**, and always perform maintenance tasks and repairs in compliance with the regulations on occupational safety and accident prevention and with the instructions by the vehicle manufacturer!
- **Prior to each use**, check the special tools **carefully** for damage, loose parts or unauthorised modifications. **Never** use it if you notice any such deficiencies!
- **Always** wear your personal protective equipment (for example safety goggles, protective gloves, safety shoes) when working!



### Observe additional instructions!

When using the wheel bearing package - KL-8041-300 the respective instructions **must** also be observed!  
**KL-0039.. Wheel Bearing Series, KL-0040-2500  
 KL-0049-31, KL-0174-.. Series**

**10. SINGLE COMPONENT OVERVIEW**

Item	Part no.	Description	Qty.
<b>A</b>	<b>KL-0174-150</b>	<b>Puller set</b>	<b>1</b>
A1	KL-0174-240	Perforated plate size 2	1
A2	KL-0174-722	Tension bolt, type B, M12 x 1.25	4
A3	KL-0174-723	Tension bolt, type B, M12 x 1.5	4
A4	KL-0174-724	Pull bolt, type B, M14 x 1.5	4
A5	KL-0174-727	Pull bolt, type B, M14 x 1.25	4
A6	KL-0174-762	Pull bolt, type M, M12 x 1.25	4
A7	KL-0174-763	Pull bolt, type M, M12 x 1.5	4
A8	KL-0174-764 A	Pull bolt, type M, M14 x 1.5	4
A9	KL-0174-701	Hexagon collar nut M14	4
A10	KL-0174-559	Adapter 2 1/4"-14UNS to 2 1/4"-14UNS	1
A11	KL-0039-1935	Thrust piece	1
<b>B</b>	<b>KL-0039-0110 K</b>	<b>Wheel bearing tool kit, mechanical</b>	<b>1</b>
B1	KL-0039-1011	Mounting adapter for mechanical spindle	1
B2	KL-0039-1002	Mounting adapter for clamping nut and thrust spindle	1
B3	KL-0040-3008	Draw spindle M20	1
B4	KL-0040-3009	Clamping nut M20	1
Not ill.	KL-0014-0030	Molybdenum disulphide paste	1
<b>B5</b>	<b>KL-0039-140</b>	<b>Set of housings</b>	<b>1</b>
B5.1	KL-0039-1415	Centring ring, 80mm diameter	1
B5.2	KL-0039-1414	Centring ring, 75mm diameter	1
B5.3	KL-0039-1413	Centring ring, 70mm diameter	1
B5.4	KL-0039-1402	Housing	1
B5.5	KL-0039-1401	Bearing cover	1
<b>B6</b>	<b>KL-0039-0101</b>	<b>Thrust/centring ring set, 16 pieces</b>	<b>1</b>
B6.1	KL-0039-1334	Centring ring, 34mm diameter	1
B6.2	KL-0039-1338	Centring ring, 38mm diameter	1
B6.3	KL 0039-1339	Centring ring, 39mm diameter	1
B6.4	KL 0039 1340	Centring ring, 40mm diameter	1
B6.5	KL 0039-1341	Centring ring, 41mm diameter	1
B6.6	KL-0039-1342	Centring ring, 42mm diameter	1
B6.7	KL-0039-1343	Centring ring, 43mm diameter	1
B6.8	KL 0039-1345	Centring ring, 45mm diameter	1
B6.9	KL-0039-1260	Thrust ring 60mm dia.	1
B6.10	KL-0039-1264	Thrust ring 64mm dia.	1
B6.11	KL-0039-1268	Thrust ring 68mm dia.	1
B6.12	KL-0039-1272	Thrust ring 72mm dia.	1
B6.13	KL-0039-1274	Thrust ring 74mm dia.	1
B6.14	KL 0039-1280	Thrust ring Ø 80mm	1
B6.15	KL-0039-1282	Thrust ring Ø 82mm	1
B6.16	KL-0039-1285	Thrust ring Ø 85mm	1
Not ill.	KL-0039-0119	Plastic case	1
<b>C</b>	<b>KL-0049-31</b>	<b>Impact puller</b>	<b>1</b>
<b>D</b>	<b>KL-0039-802</b>	<b>Hydraulic drive without hydraulic cylinder</b>	<b>1</b>
D1	KL-0039-1920	Pulling spindle M20, with clamping nut	1
D2	KL-0039-1002	Adapter for clamping nut	1
D3	KL-0039-1003	Retaining adapter for hydraulic cylinder	1
<b>E</b>	<b>KL-0039-1930</b>	<b>Thrust spindle M20x350 with O-ring</b>	<b>1</b>
<b>F</b>	<b>KL-0040-2500</b>	<b>Hydraulic cylinder 17t</b>	<b>1</b>

## GEDORE-Werkzeugfabrik GmbH & Co. KG

Remscheider Straße 149  
42899 - Remscheid  
Postfach 120361  
47873 Remscheid  
GERMANY

### Vertrieb DEUTSCHLAND

☎ +49 (0) 2191 / 596-0  
☎ +49 (0) 2191 / 596-230  
✉ info@gedore.com  
🌐 www.gedore.com

### Sales INTERNATIONAL

☎ +49 (0) 2191 / 596-910  
☎ +49 (0) 2191 / 596-911  
✉ info@gedore.com  
🌐 www.gedore.com

## GEDORE TOOLS, INC.

Only for USA, Canada & Mexico  
Sólo para EE.UU., Canadá y México  
Seulement pour les USA, le Canada et le Mexique  
7187 Bryhawke Circle, Suite 700, North Charleston, SC 29418, USA

☎ +1-843 / 225 50 15  
☎ +1-843 / 225 50 20  
✉ info@gedoretools.com  
🌐 www.gedoretools.com

Worldwide GEDORE service centers and offices are listed on the Internet at: [www.gedore.com](http://www.gedore.com)

## GEDORE Automotive GmbH

Breslauer Straße 41  
78166 - Donaueschingen  
Postfach 1329  
78154 Donaueschingen  
GERMANY

### Vertrieb DEUTSCHLAND

☎ +49 (0) 771 / 8 32 23-0  
☎ +49 (0) 771 / 8 32 23-90  
✉ info.gam@gedore.com  
🌐 gedore-automotive.com



[www.gedore-automotive.com](http://www.gedore-automotive.com)