

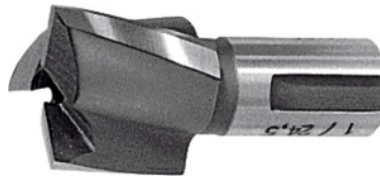

Modular counterbore, Size / counterbore Ø: 0/15mm



Order data

| | |
|--------------|---------------|
| Order number | 156730 0/15 |
| GTIN | 4033591011977 |
| Item class | 16C |

Description

Version:

Very good machining and ideal chip evacuation due to spiral flutes. **Easy to regrind.** Counterbore is protected against turning in the holder.

Application:

For counterboring screw heads to DIN or **by means of an appropriate combination of counterbore and pilot to produce stepped holes or non-standard counterbores.**

Note:

Counterbores available on request also in HSS with optional TIN coating and brazed-on carbide tips with form "T" ISO inserts.

Technical description

| | |
|---------------------------|-------------------------|
| Counterbore Ø | 15 mm |
| Number of cutting edges Z | 3 |
| Cutter length | 14 mm |
| Shank Ø | 10 mm |
| Countersink angle | 180 degrees |
| Coating | uncoated |
| Tool material | HSS |
| Standard | Manufacturer's standard |

| | |
|-----------------|----------------------------------|
| Through-coolant | yes |
| Type of product | Cutter insert for countersinking |

User data

| | Suitability | V_c | ISO code |
|--------------------------------|-------------------------------------------|----------|----------|
| Alu plastics | suitable | 40 m/min | N |
| Aluminium (short chipping) | suitable | 60 m/min | N |
| Alu > 10% Si | suitable only under restricted conditions | 20 m/min | N |
| Steel < 500 N/mm ² | suitable | 25 m/min | P |
| Steel < 750 N/mm ² | suitable | 20 m/min | P |
| Steel < 900 N/mm ² | suitable | 15 m/min | P |
| Steel < 1100 N/mm ² | suitable only under restricted conditions | 10 m/min | P |
| Steel < 1400 N/mm ² | suitable only under restricted conditions | 5 m/min | P |
| INOX < 900 N/mm ² | suitable only under restricted conditions | 5 m/min | M |
| wet maximum | suitable | | |