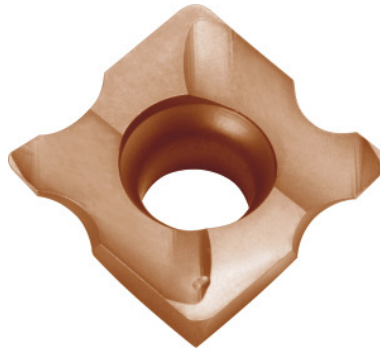

Garant**Radius indexable insert, HB225, Type / Radius R: 16/2****Order data**

Order number	231527 16/2
GTIN	4062406565565
Item class	21Y

Description**Version:**

2-cutter radius indexable inserts.

Application:

For convex radii on external \varnothing or in holes.

Suitable for:

No. 231500 size 16

X: 3.75 mm

Y: 1.5 mm

Z: 3.5 mm

Technical description

L	11.11 mm
X	3.75 mm
S	3.97 mm
Coating	AlCrN
Number of changes/inserts	2

Type	16
Z	3.5 mm
Radius R	2 mm
Y	1.5 mm
Grade	HB225
Tool material	Carbide
Type of product	Indexable insert for drilling

User data

	Suitability	V _c	ISO code
Alu plastics	suitable	250 m/min	N
Aluminium (short chipping)	suitable	250 m/min	N
Alu > 10% Si	suitable	250 m/min	N
Steel < 500 N/mm ²	suitable	200 m/min	P
Steel < 750 N/mm ²	suitable	150 m/min	P
Steel < 900 N/mm ²	suitable	150 m/min	P
Steel < 1100 N/mm ²	suitable	150 m/min	P
Steel < 1400 N/mm ²	suitable	150 m/min	P
INOX < 900 N/mm ²	suitable	90 m/min	M
INOX > 900 N/mm ²	suitable	80 m/min	M
Ti > 850 N/mm ²	suitable	65 m/min	S
GG(G)	suitable	110 m/min	K
CuZn	suitable	250 m/min	N
wet maximum	suitable		
dry	suitable only under restricted conditions		