

Clamping device, suitable for type: M5-20

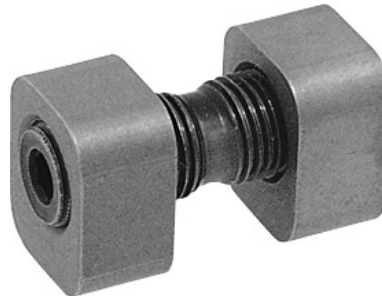

Order data

Order number	333630 M5-20
GTIN	4045197312747
Item class	35D

Description

Version:

Clamping device for square on tap.

Suitable for :

Edalmatic tapping head No. 333500.

Supplied with:

1 clamping screw, 1 left-hand clamp, and 1 right-hand clamp.

Clamping screw thread: M10×1

Length clamping jaw: 18 mm

Width clamping jaw: 15 mm

Technical description

Clamping screw thread	M10×1
Width clamping jaw	15 mm
suitable for clamping range	M5-20
Length clamping jaw	18 mm
Type of product	Clamping fixture

