

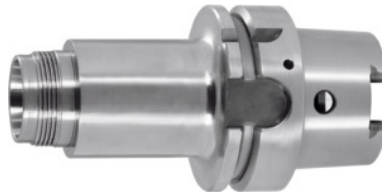

Precision ER collet chuck CENTRO P, HSK-A 63 A = 160, Type CP for ER: 16



Order data

Order number	305930 16
GTIN	2050001703491
Item class	33F

Description

Version:

Alternatively for CENTRO P– without seals, with ER clamping nut Centro P No. 309655 **or sealed system** with ER clamping nut CP for HP sealing rings No. 309665 in conjunction with HP sealing rings No.309666 – 309668 (for internal coolant supply or as a dirt trap).

- **Ground externally and internally with RFID / Balluffchip bore.**
- **Concentricity and repetition accuracy 3 µm at 3×D, maximum 50 mm when using a HP precision collet.**
- **HDC = Heavy Duty Chuck, a mount specially designed for rough machining. A reinforced chuck body ensures better stability and plenty of radial stiffness. Ball-bearing clamping nut with trapezoidal-shaped fine thread for optimum tightening torques and clamping forces reduces vibration.**
- **Very high clamping forces due to the collet fully seated in the chuck and coated clamping nut.**
- **Vibration damping due to the element collet and mass of the chuck.**

Advantage:

Patented optimum seating of the collet, double guides, trapezoidal thread and low-friction coated clamping nut amalgamate when clamped into a sturdy unit, thus ensuring a very high degree of rigidity and precision.

Application:

For high precision clamping of tools with plain shanks.

Supplied with:

Without clamping nut.

Optional extras:

Coolant pipe No. 309880, socket wrench No. 309890, precision ER collets for HP No. 309368 – 309381, and for taps No. 309402 – 309419 (not for Horex), ER CP clamping nuts No. 309655;

309665, ER HDC clamping nuts No. 309657, HP sealing rings No. 309666 – 309668, CP roller bearing wrenches No. 309754; 309756, HDC roller bearing wrenches No. 309745/309756.

Note:

- **Clamps only nominal \varnothing up to shank \varnothing tolerance h10.**
- **Use in combination with Fahrion collets.**

Machining strategy: HSC

Shape: A

Concentricity ER collet with HDC collet chuck: $\leq 6 \mu\text{m}$

Concentricity HP collet with HDC collet chuck: $\leq 3 \mu\text{m}$

Clamping range: 1 - 10 mm

Overhang dimension A: 160 mm

External \varnothing D: 30 mm

Technical description

Overhang dimension A	160 mm
Clamping range	1 - 10 mm
Type CP for ER	16
External \varnothing D	30 mm
Shape	A
Series	Centro P
Concentricity HP collet with HDC collet chuck	$\leq 3 \mu\text{m}$
Concentricity ER collet with HDC collet chuck	$\leq 6 \mu\text{m}$
Adapter	HSK-A 63 A = 160
Arbor standard	DIN 69893
Arbor standard	ISO 12164-1
Balance quality G at rotational speed	G 2.5 at 25,000 rpm
Concentricity ER collet with CP collet chuck	$\leq 6 \mu\text{m}$
Concentricity HP collet with CP collet chuck	$\leq 3 \mu\text{m}$
Machining strategy	HSC
Type of product	Collet chuck

Accessories

ER collet for machine taps with seal Nominal clamping Ø d 7 mm	309402 7
ER collet HP Nominal clamping Ø d 2 mm	309370 2
ER collet for machine taps with seal and spray nozzles Nominal clamping Ø d 3,5 mm	309404 3,5
ER collet HP with seal Nominal clamping Ø d 6 mm	309371 6
CP roller bearing wrench for torque wrenches Type 16	309756 16
ER collet HP Nominal clamping Ø d 6 mm	309370 6
ER collet HP with seal and spray nozzles Nominal clamping Ø d 6 mm	309372 6
ER collet for machine taps with seal Nominal clamping Ø d 8 mm	309402 8
ER collet for machine taps with seal and spray nozzles Nominal clamping Ø d 7 mm	309404 7
ER collet HP Nominal clamping Ø d 3 mm	309370 3
ER collet HP with seal Nominal clamping Ø d 8 mm	309371 8
ER collet for machine taps with seal Nominal clamping Ø d 4 mm	309402 4
Sealing ring HP for ER clamping nut CENTRO P Clamping Ø (1 mm increments) 2 mm	309666 2
ER collet HP Nominal clamping Ø d 9 mm	309370 9
ER collet HP with seal Nominal clamping Ø d 7 mm	309371 7
ER collet HP with seal and spray nozzles Nominal clamping Ø d 4 mm	309372 4
ER collet set HP (3; 4; 5; 6; 8; 10mm), 426 E	309390
ER collet for machine taps with seal Nominal clamping Ø d 2,8 mm	309402 2,8
ER collet set HP with seal (3; 4; 5; 6; 8; 10mm), 425 E	309391
ER collet HP Nominal clamping Ø d 1 mm	309370 1
ER collet for machine taps with seal and spray nozzles Nominal clamping Ø d 6 mm	309404 6
	309402 4,5

ER collet for machine taps with seal Nominal clamping Ø d 4,5 mm

ER collet HP with seal Nominal clamping Ø d 10 mm	309371 10
ER collet HP with seal Nominal clamping Ø d 9 mm	309371 9
Sealing ring HP for ER clamping nut CENTRO P Clamping Ø (1 mm increments) 1 mm	309666 1
ER collet for machine taps with seal Nominal clamping Ø d 3,5 mm	309402 3,5
ER collet HP Nominal clamping Ø d 8 mm	309370 8
ER collet HP Nominal clamping Ø d 7 mm	309370 7
ER collet for machine taps with seal Nominal clamping Ø d 6 mm	309402 6
CP roller bearing wrench Type 16	309754 16
ER collet for machine taps with seal and spray nozzles Nominal clamping Ø d 8 mm	309404 8
ER collet HP with seal Nominal clamping Ø d 4 mm	309371 4
ER collet HP Nominal clamping Ø d 4 mm	309370 4
ER collet for machine taps with seal and spray nozzles Nominal clamping Ø d 4,5 mm	309404 4,5
ER collet HP Nominal clamping Ø d 5 mm	309370 5
ER collet HP with seal and spray nozzles Nominal clamping Ø d 8 mm	309372 8
ER collet HP with seal Nominal clamping Ø d 3 mm	309371 3
ER collet for machine taps with seal Nominal clamping Ø d 9 mm	309402 9
ER collet HP with seal Nominal clamping Ø d 5 mm	309371 5
ER collet HP Nominal clamping Ø d 10 mm	309370 10