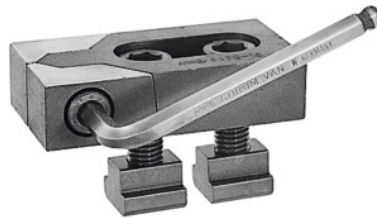

**Pair of low height clamping jaws Bulle with accessories, Slot width a: 20mm****Order data**

| | |
|--------------|---------------|
| Order number | 375110 20 |
| GTIN | 4020772073008 |
| Item class | 35A |

Description**Version:**

Flat design, no protruding T-bolts. Clamps at any angle to table slot. When the side screw is tightened, the component is securely clamped down on to the table by the wedge effect.

Application:

For lateral clamping of flat plates directly on the machine table.

Material:

Hardened steel, burnished finish.

Supplied with:

2 fastening screws, DIN 912, 10.9, T-nuts, and hexagon key L-wrench ISO 2936 C.

Note:

Only supplied in pairs!

Technical description

| | |
|---------------------|--------|
| Height | 25 mm |
| for clamping screws | M16 |
| Length | 100 mm |
| Width | 50 mm |
| Slot width a | 20 mm |
| Type | 6490 |

Type of product

Side clamps