

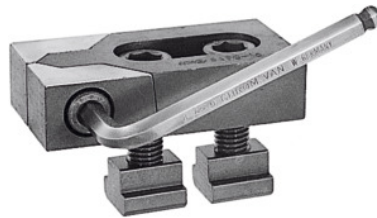

## Pair of low height clamping jaws Bulle with accessories, Slot width a: 28mm



### Order data

Order number	375110 28
GTIN	4020772073039
Item class	35A

### Description

**Version:**

Flat design, no protruding T-bolts. Clamps at any angle to table slot. When the side screw is tightened, the component is securely clamped down on to the table by the wedge effect.

**Application:**

**For lateral clamping of flat plates** directly on the machine table.

**Material:**

Hardened steel, burnished finish.

**Supplied with:**

2 fastening screws, DIN 912, 10.9, T-nuts, and hexagon key L-wrench ISO 2936 C.

**Note:**

Only supplied in pairs!

### Technical description

for clamping screws	M24
Height	30 mm
Width	78 mm
Length	140 mm
Slot width a	28 mm
Type	6490

Type of product

Side clamps