

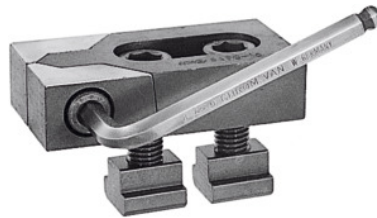

Pair of low height clamping jaws Bulle with accessories, Slot width a: 18mm



Order data

Order number	375110 18
GTIN	4020772072995
Item class	35A

Description

Version:

Flat design, no protruding T-bolts. Clamps at any angle to table slot. When the side screw is tightened, the component is securely clamped down on to the table by the wedge effect.

Application:

For lateral clamping of flat plates directly on the machine table.

Material:

Hardened steel, burnished finish.

Supplied with:

2 fastening screws, DIN 912, 10.9, T-nuts, and hexagon key L-wrench ISO 2936 C.

Note:

Only supplied in pairs!

Technical description

for clamping screws	M16
Width	50 mm
Slot width a	18 mm
Height	25 mm
Length	100 mm
Type	6490

Type of product

Side clamps